

Austin's Atlas Open Source Austin Talk

**Excavating Empirical Data**

April 18 2016

Scanned Projects

(sorry some of the lighter pencil lines didn't show up!)



Name/Pen name (anonymity is fine too):

9 MONTHS at this place

Open Austin Talk / Austin's Atlas Survey Part 1

How long have you lived in Austin?

14 years

Do you rent or own?

Rent

Do you reside in a house, apartment, condo, mobile home, or apartment?

What floor do you live on? (or do you live on multiple floors)?

second

What is your most common mode of transport?

Bus

What is that mode of transport most influenced by: convenience, philosophy, economic, traffic, other \_\_\_\_\_.

How many miles do you travel to get to work/school (or where you go everyday)?

I don't know

How long does it take to travel that distance?

35

Do you enjoy your commute? Why or why not?

It's OK. It's quiet

Open Austin Talk / Austin's Atlas Survey Part 2

A) Mark where you live on the adjacent map. You can be as vague (just use a dot) or as specific (include cross streets) as you like.

B) Visualize the window in your home that you look out the most--what do you see? Draw and describe with words in as much detail as possible below. Bring the view to life.

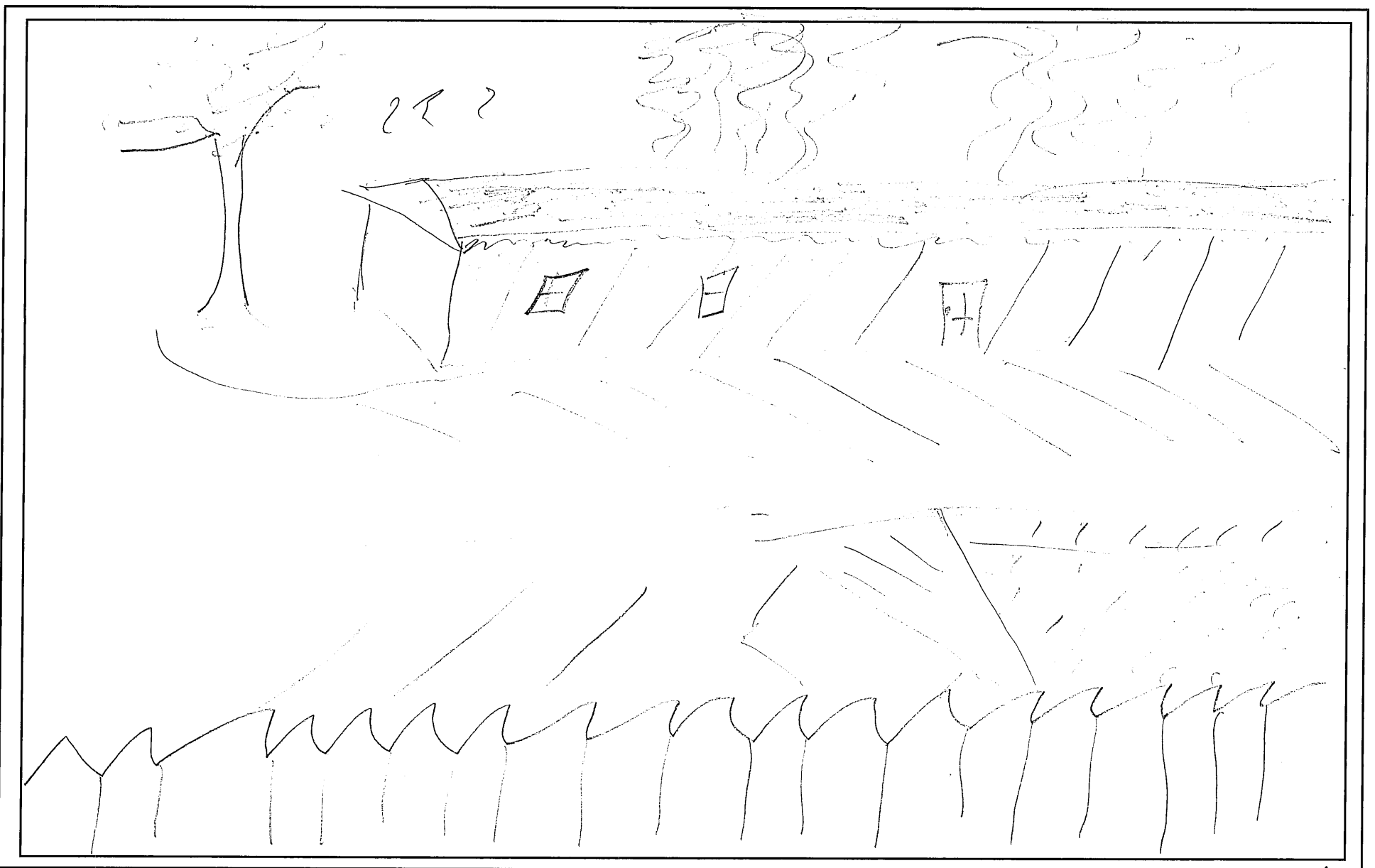
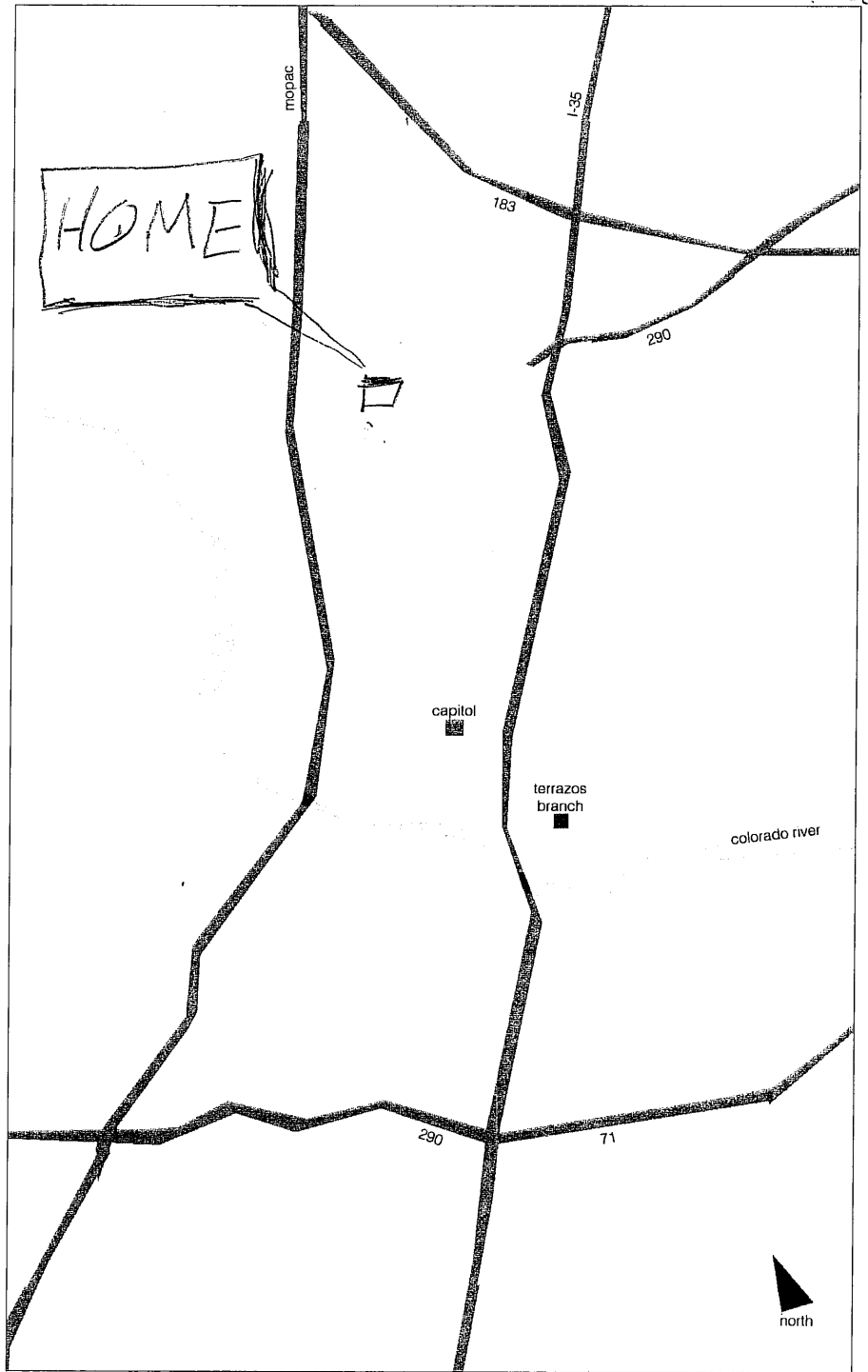

Written description/annotations of what you see out of your chosen window:

Window Frame

My bedroom window looks out on a parking lot shared between some kind of new-age healing center & a desert stereo-repair shop. I almost always have the blinds shut.

Name/Pen name (anonymity is fine too):

JOHN CLARY

Open Austin Talk / Austin's Atlas Survey Part 1

How long have you lived in Austin? 4 YRS

Do you rent or own? RENT

Do you reside in a house, apartment, condo, mobile home, or GARAGE?

What floor do you live on? (or do you live on multiple floors)? 2

What is your most common mode of transport? BICYCLE

What is that mode of transport most influenced by: convenience, philosophy, economic, traffic, other

How many miles do you travel to get to work/school (or where you go everyday)? 7.5 MI x 2

How long does it take to travel that distance? 40 MIN

Do you enjoy your commute? Why or why not?

IT HAS ITS MOMENTS

Open Austin Talk / Austin's Atlas Survey Part 2

A) Mark where you live on the adjacent map. You can be as vague (just use a dot) or as specific (include cross streets) as you like.

B) Visualize the window in your home that you look out the most--what do you see? Draw and describe with words in as much detail as possible below. Bring the view to life.

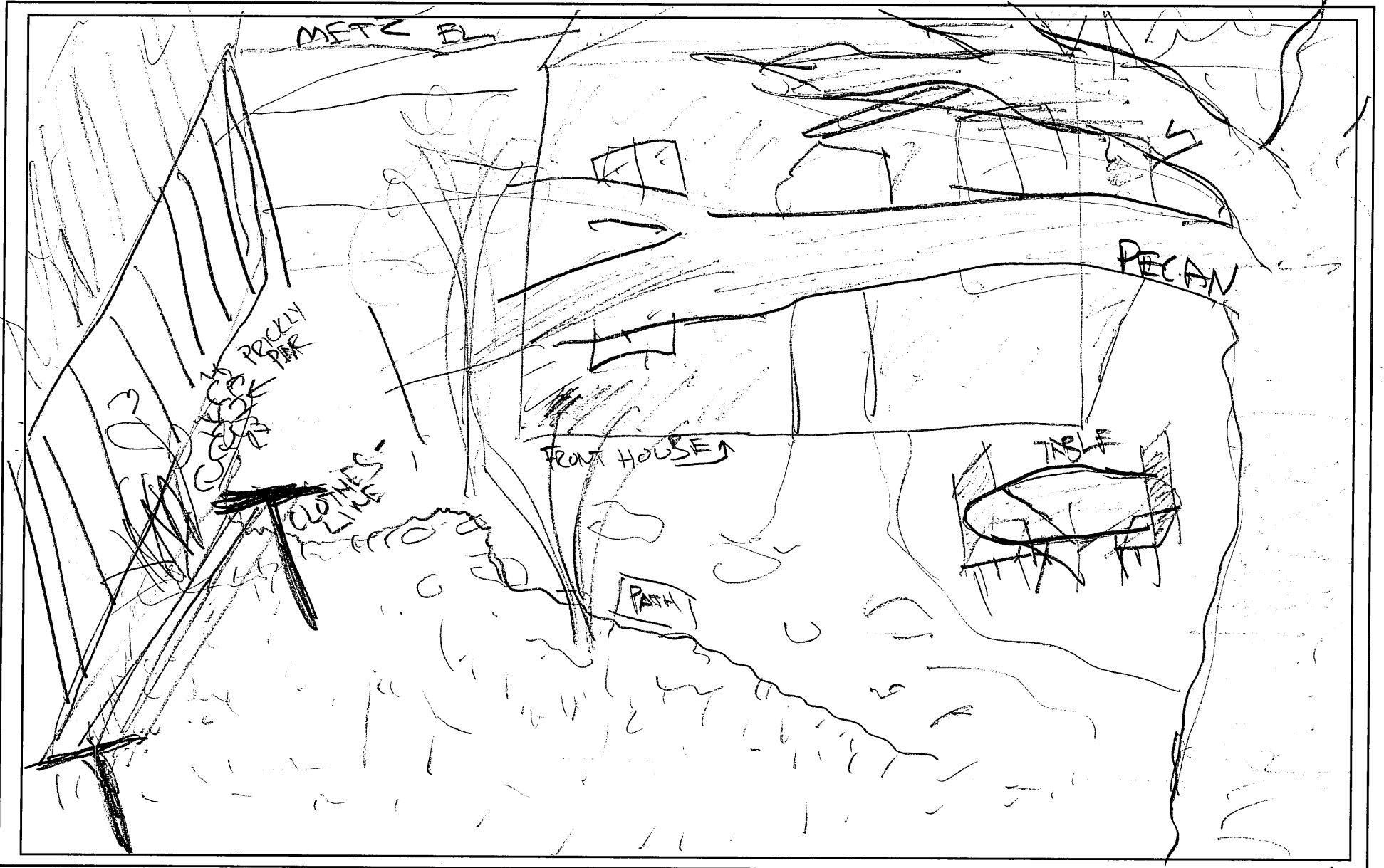
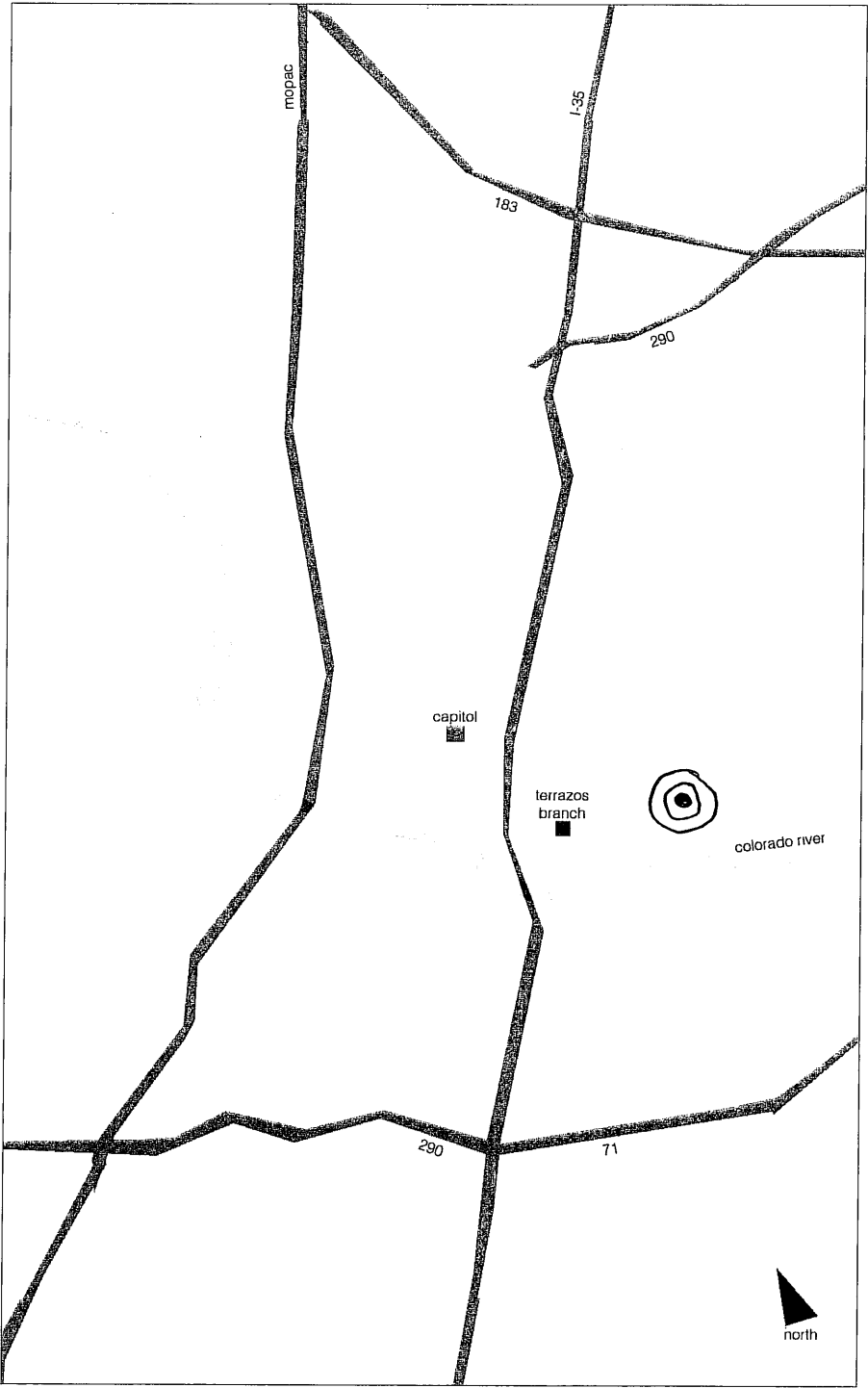

Written description/annotations of what you see out of your chosen window:

LOOKING OUT THE LIVING ROOM WINDOW FROM ABOVE THE GARAGE INTO THE BACK YARD ITS VERY GREEN AND THERE'S A PECAN AND A CLOTHESLINE AND TABLE AND NOT PICTURED: (CATS)

Window Frame

Name/Pen name (anonymity is fine too):

Ann

Open Austin Talk / Austin's Atlas Survey Part 1

How long have you lived in Austin? 10 yrs

Do you rent or own? both

Do you reside in a house, apartment, condo, mobile home, or Tiny House?

What floor do you live on? (or do you live on multiple floors)? first

What is your most common mode of transport? car

What is that mode of transport most influenced by: convenience, philosophy, economic, traffic, other Time

How many miles do you travel to get to work/school (or where you go everyday)? 10

How long does it take to travel that distance? 30 mins @ rush hr,

Do you enjoy your commute? Why or why not? Too much time in traffic

Open Austin Talk / Austin's Atlas Survey Part 2

A) Mark where you live on the adjacent map. You can be as vague (just use a dot) or as specific (include cross streets) as you like.

B) Visualize the window in your home that you look out the most--what do you see? Draw and describe with words in as much detail as possible below. Bring the view to life.

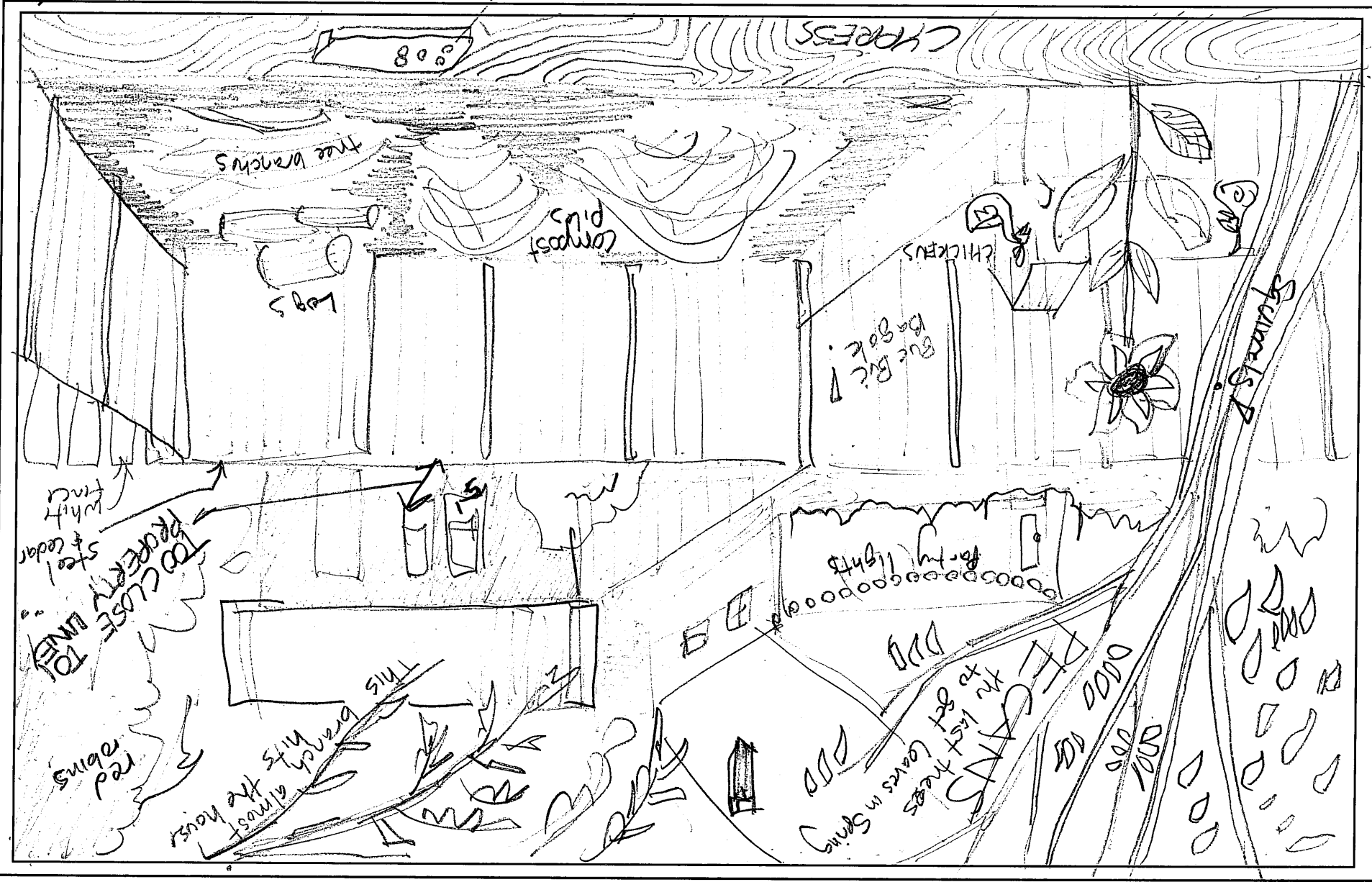
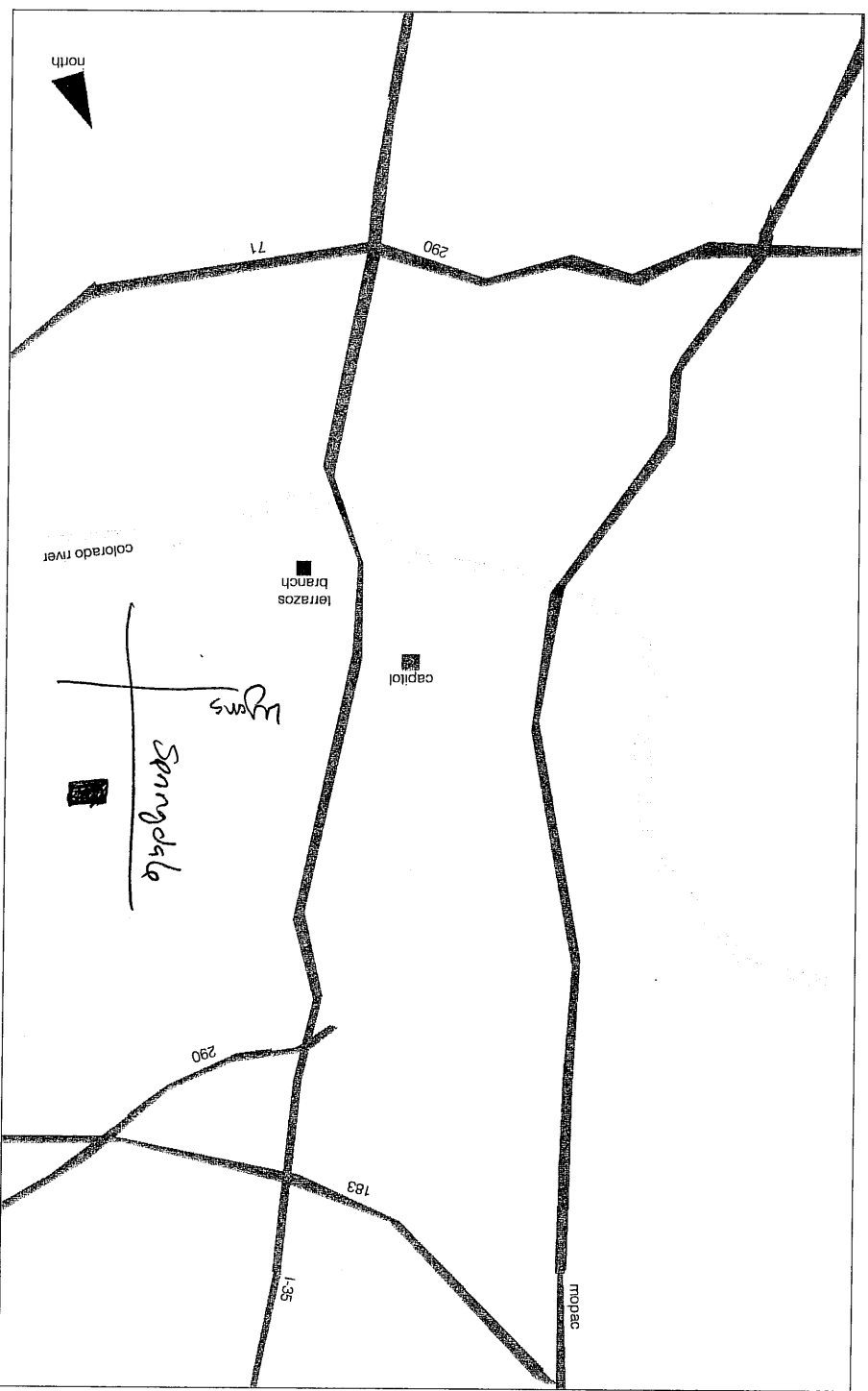

Written description/annotations of what you see out of your chosen window:

It feels like a farm sometimes, but I love it. flies & all, (a view to the back yard)

Window Frame

fan central

Name/Pen name (anonymity is fine too):

YUNG AMALEZZY

**Open Austin Talk / Austin's Atlas Survey Part 1**

How long have you lived in Austin?

7 years

Do you rent or own?

Rent

Do you reside in a house, apartment, condo, mobile home, or \_\_\_\_\_?

apartment

What floor do you live on? (or do you live on multiple floors)?

4th

What is your most common mode of transport?

walk

What is that mode of transport most influenced by:

convenience, philosophy, economic, traffic, other all of the above (wrecked car, don't need a new one)

How many miles do you travel to get to work/school (or where you go everyday)?

~3 miles

How long does it take to travel that distance?

~15 min

Do you enjoy your commute? Why or why not?

yes! biking in the morning is exhilarating

**Open Austin Talk / Austin's Atlas Survey Part 2**

A) Mark where you live on the adjacent map. You can be as vague (just use a dot) or as specific (include cross streets) as you like.

B) Visualize the window in your home that you look out the most--what do you see? Draw and describe with words in as much detail as possible below. Bring the view to life.

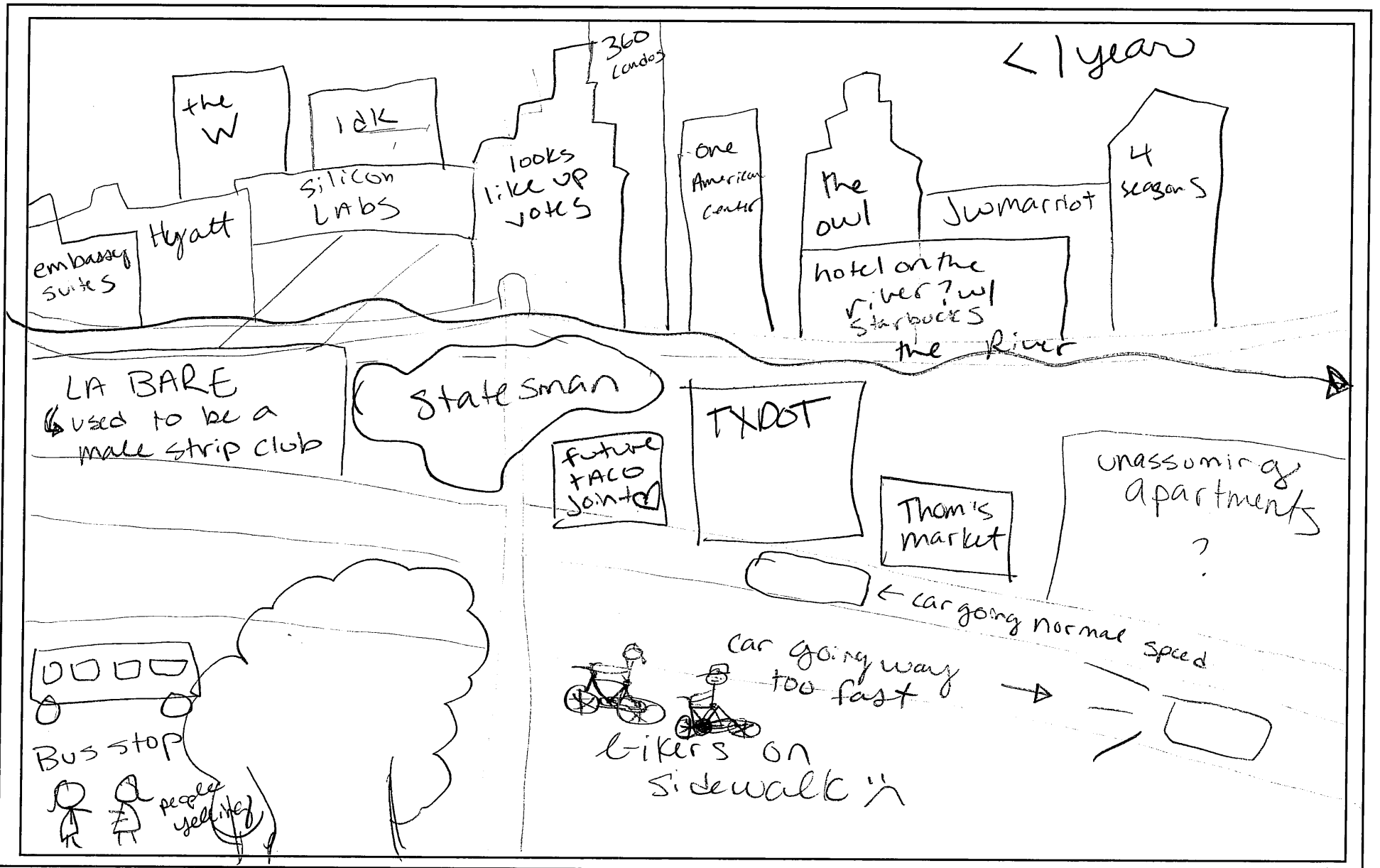
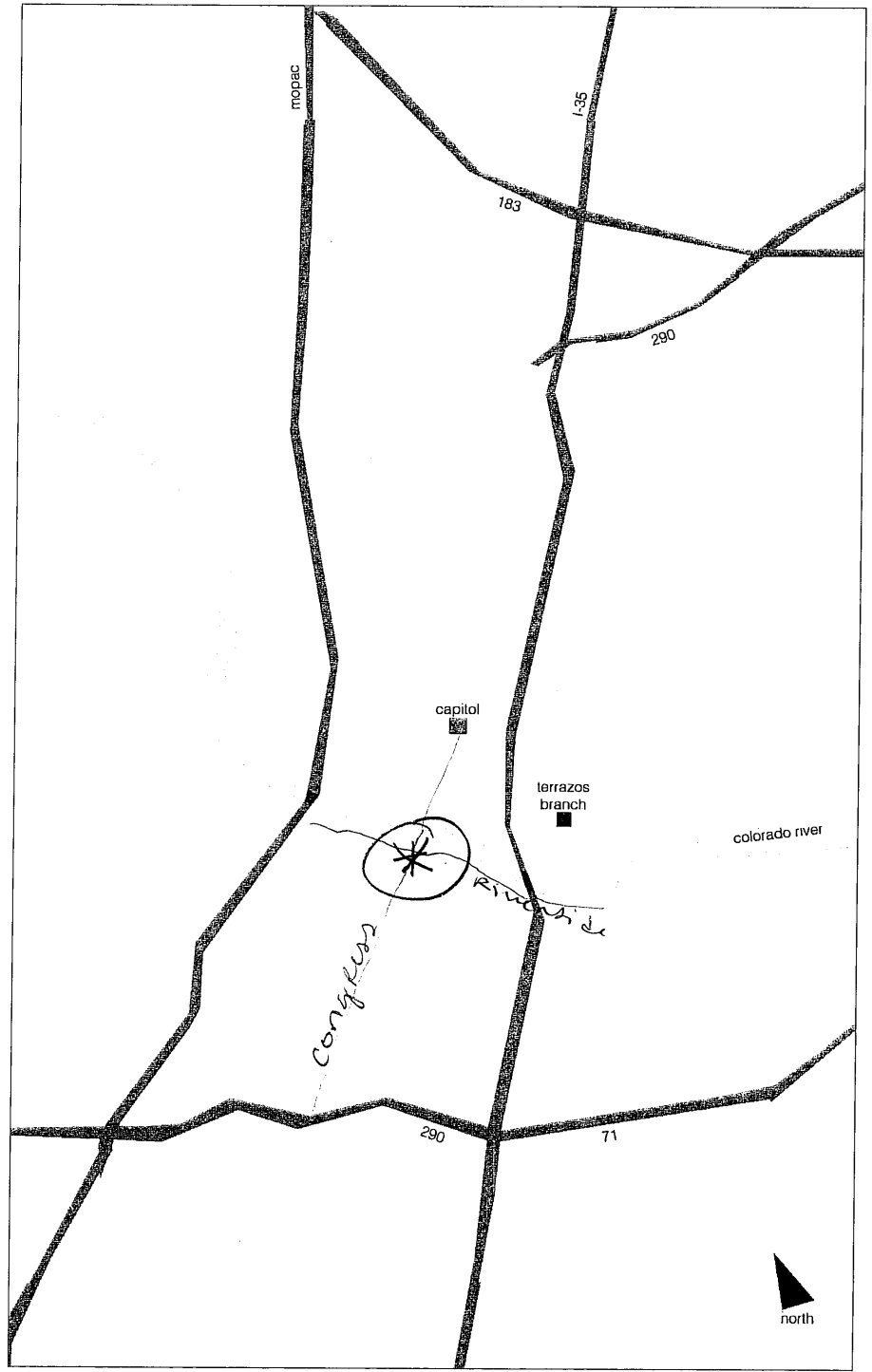

Written description/annotations of what you see out of your chosen window:

Window Frame

Name/Pen name (anonymity is fine too):

MATEO

Open Austin Talk / Austin's Atlas Survey Part 1

How long have you lived in Austin? 7 1/2 YRS

Do you rent or own? RENT

Do you reside in a house, apartment, condo, mobile home, or \_\_\_\_\_? HOUSE

What floor do you live on? (or do you live on multiple floors)? 1ST FLOOR

What is your most common mode of transport? CAR !! but BIKE is better!

What is that mode of transport most influenced by: convenience, philosophy, economic, traffic, other TIME.

How many miles do you travel to get to work/school (or where you go everyday)? 4.6 MILES

How long does it take to travel that distance? ~15 MINUTES

Do you enjoy your commute? Why or why not? YES! LOTS OF FUN PLACES TO STOP ALONG THE WAY. WINDY ROADS.

Open Austin Talk / Austin's Atlas Survey Part 2

A) Mark where you live on the adjacent map. You can be as vague (just use a dot) or as specific (include cross streets) as you like.

B) Visualize the window in your home that you look out the most--what do you see? Draw and describe with words in as much detail as possible below. Bring the view to life.

I'VE LIVED HERE FOR ALMOST (2) YEARS!

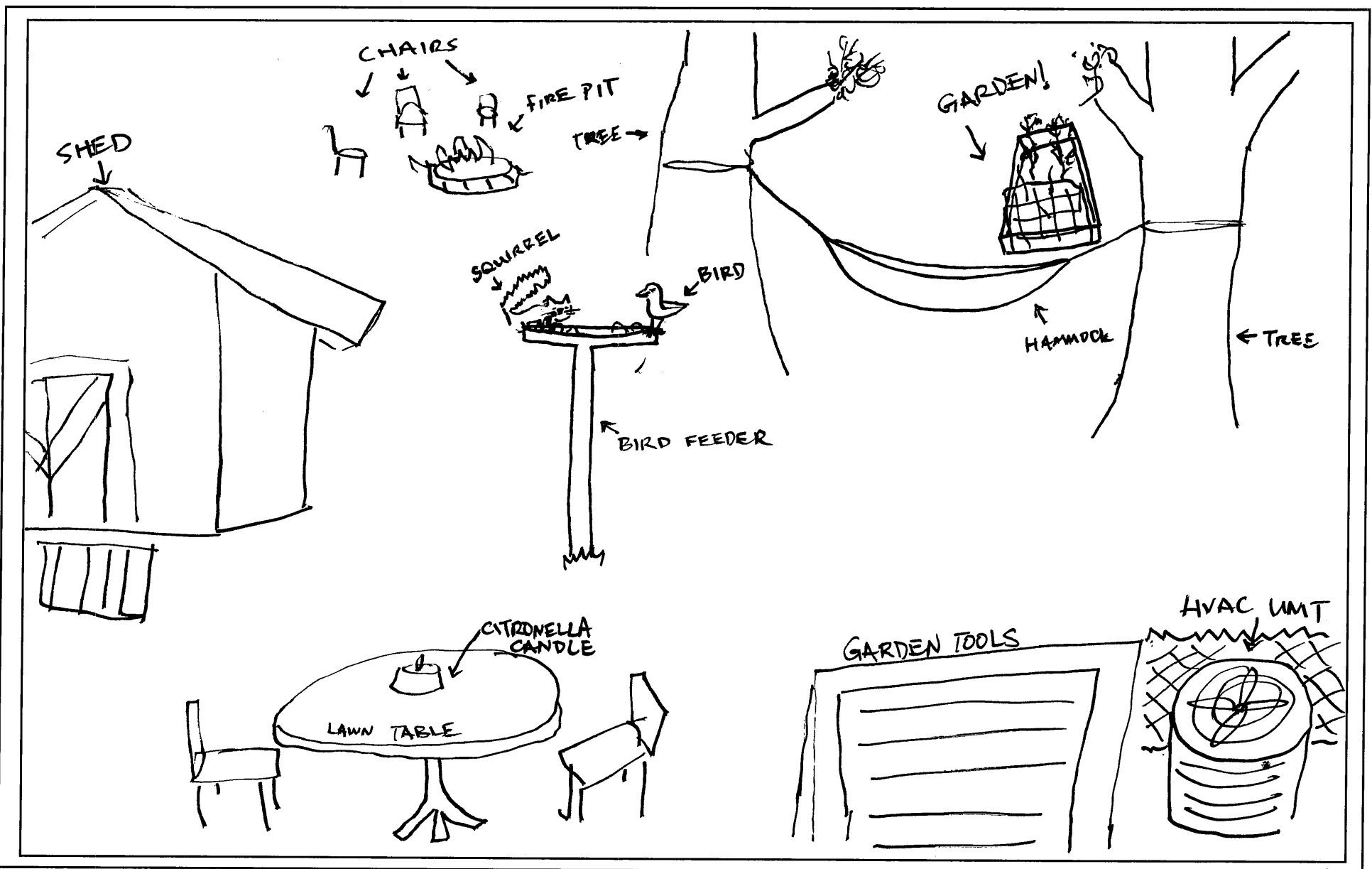
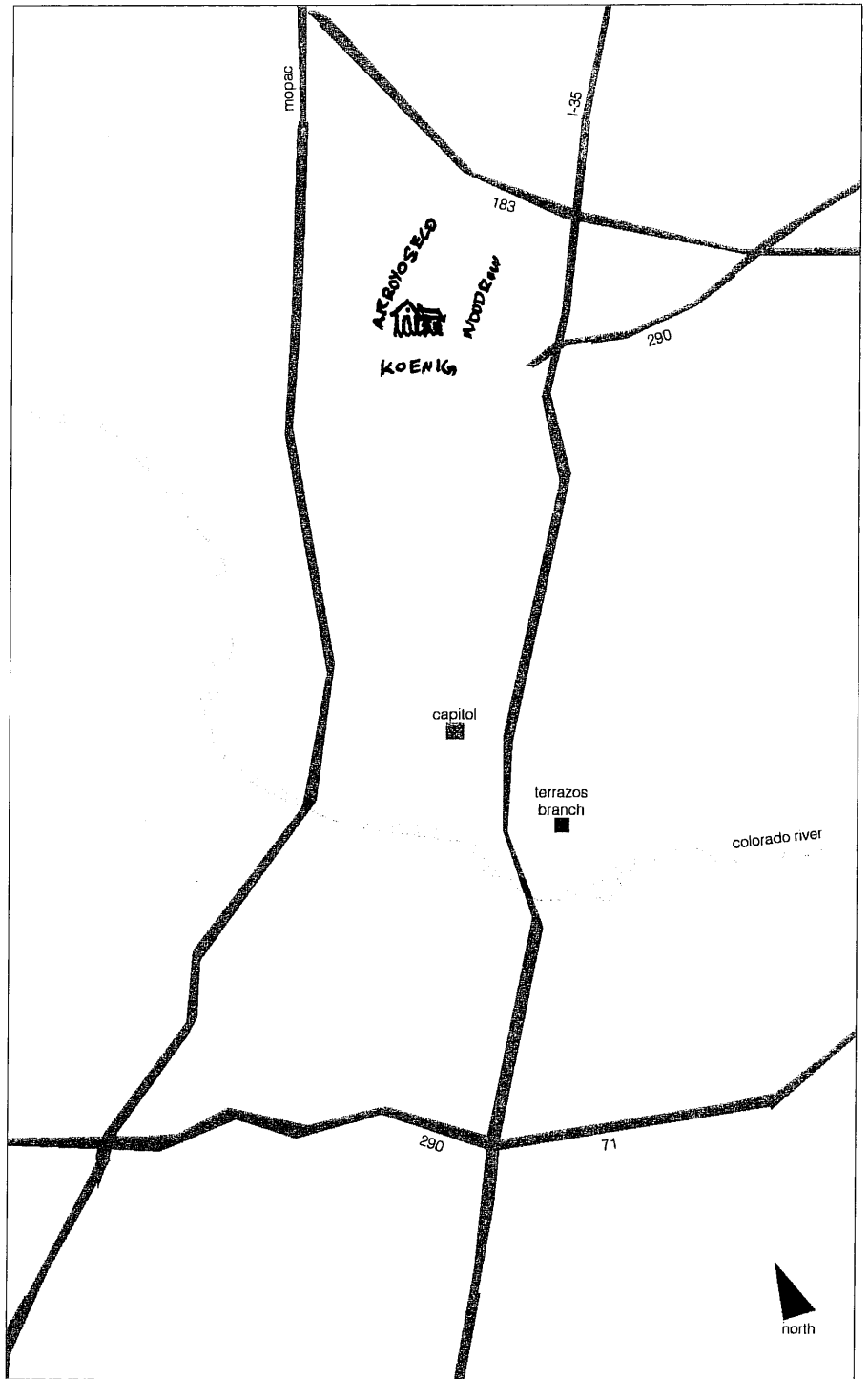

Written description/annotations of what you see out of your chosen window:

Window Frame

Backyard as seen through the window next to my bed.



Name/Pen name (anonymity is fine too):

Michelle Schulze

**Open Austin Talk / Austin's Atlas Survey Part 1**

How long have you lived in Austin? 15 years

Do you rent or own? own

Do you reside in a house, apartment, condo, mobile home, or house?

What floor do you live on? (or do you live on multiple floors)? NA

What is your most common mode of transport? car

What is that mode of transport most influenced by: convenience, philosophy, economic, traffic, other necessity.

How many miles do you travel to get to work/school (or where you go everyday)? I work from home, kids ride the bus. On school days (for me) I travel.  
How long does it take to travel that distance? 18 miles round trip

Do you enjoy your commute? Why or why not?  
no.

**Open Austin Talk / Austin's Atlas Survey Part 2**

A) Mark where you live on the adjacent map. You can be as vague (just use a dot) or as specific (include cross streets) as you like.

B) Visualize the window in your home that you look out the most--what do you see? Draw and describe with words in as much detail as possible below. Bring the view to life.

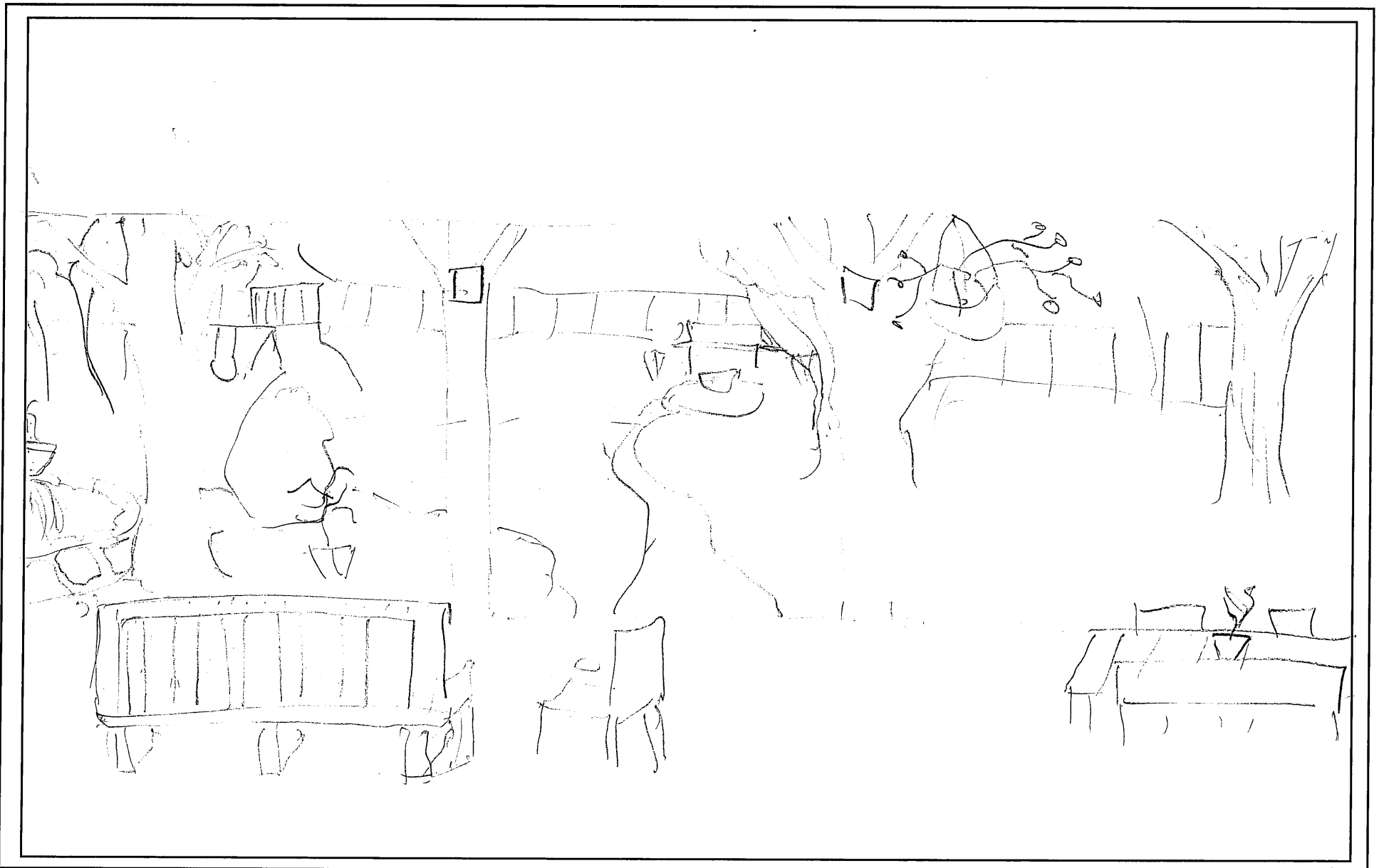
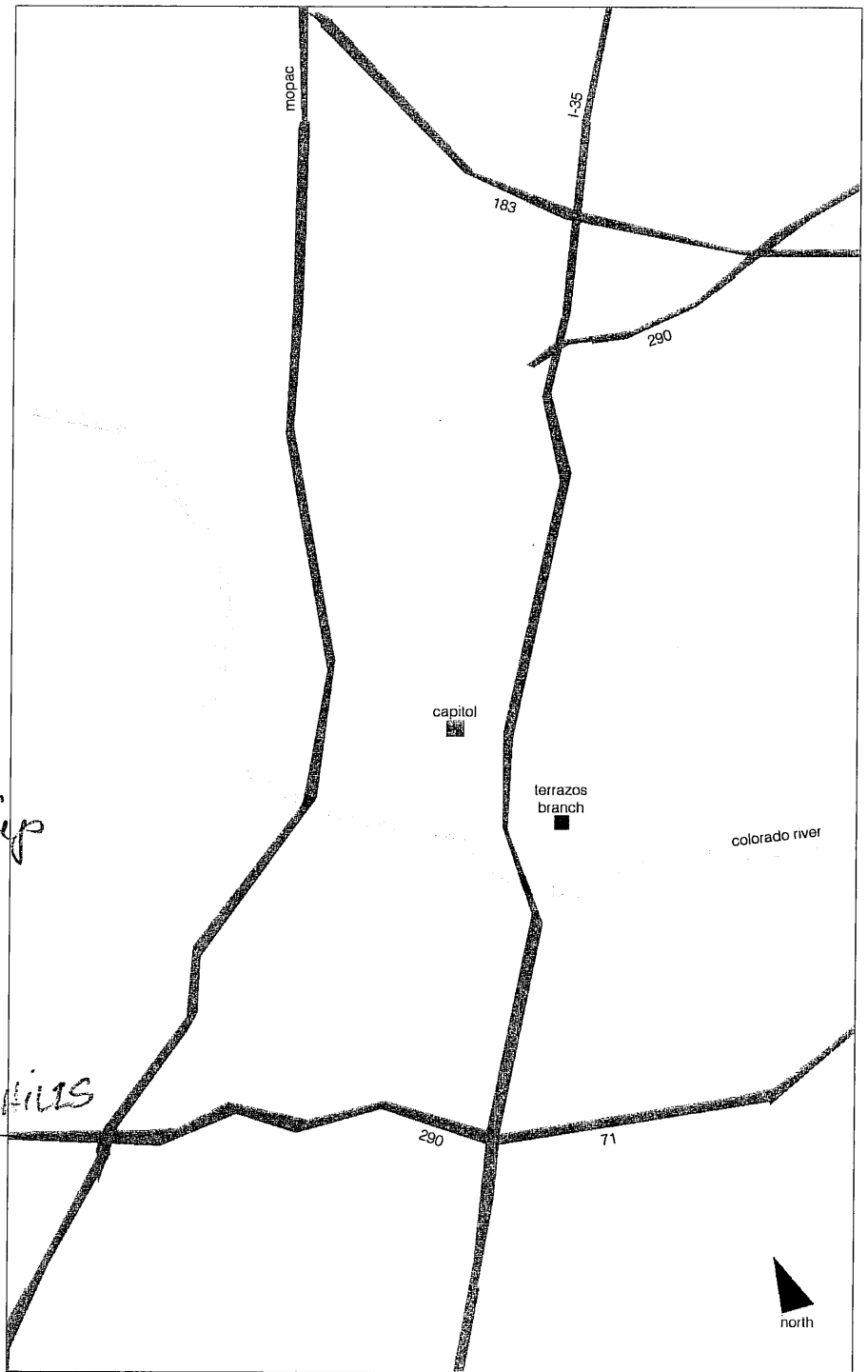

Written description/annotations of what you see out of your chosen window:

Window Frame

This is the window in my kitchen over the sink. It's the reason we bought the house 15 years ago.

Name/Pen name (anonymity is fine too):

Matt

**Open Austin Talk / Austin's Atlas Survey Part 1**

How long have you lived in Austin?

4 years

Do you rent or own?

own

Do you reside in a house, apartment, condo, mobile home, or \_\_\_\_\_?

house

What floor do you live on? (or do you live on multiple floors)?

What is your most common mode of transport?

car

What is that mode of transport most influenced by: convenience, philosophy, economic, traffic, other \_\_\_\_\_.

lack of alternatives in my area

How many miles do you travel to get to work/school (or where you go everyday)?

none, work from home

How long does it take to travel that distance?

Do you enjoy your commute? Why or why not?

I'm glad I don't have one, but miss spending time downtown

**Open Austin Talk / Austin's Atlas Survey Part 2**

A) Mark where you live on the adjacent map. You can be as vague (just use a dot) or as specific (include cross streets) as you like.

B) Visualize the window in your home that you look out the most--what do you see? Draw and describe with words in as much detail as possible below. Bring the view to life.

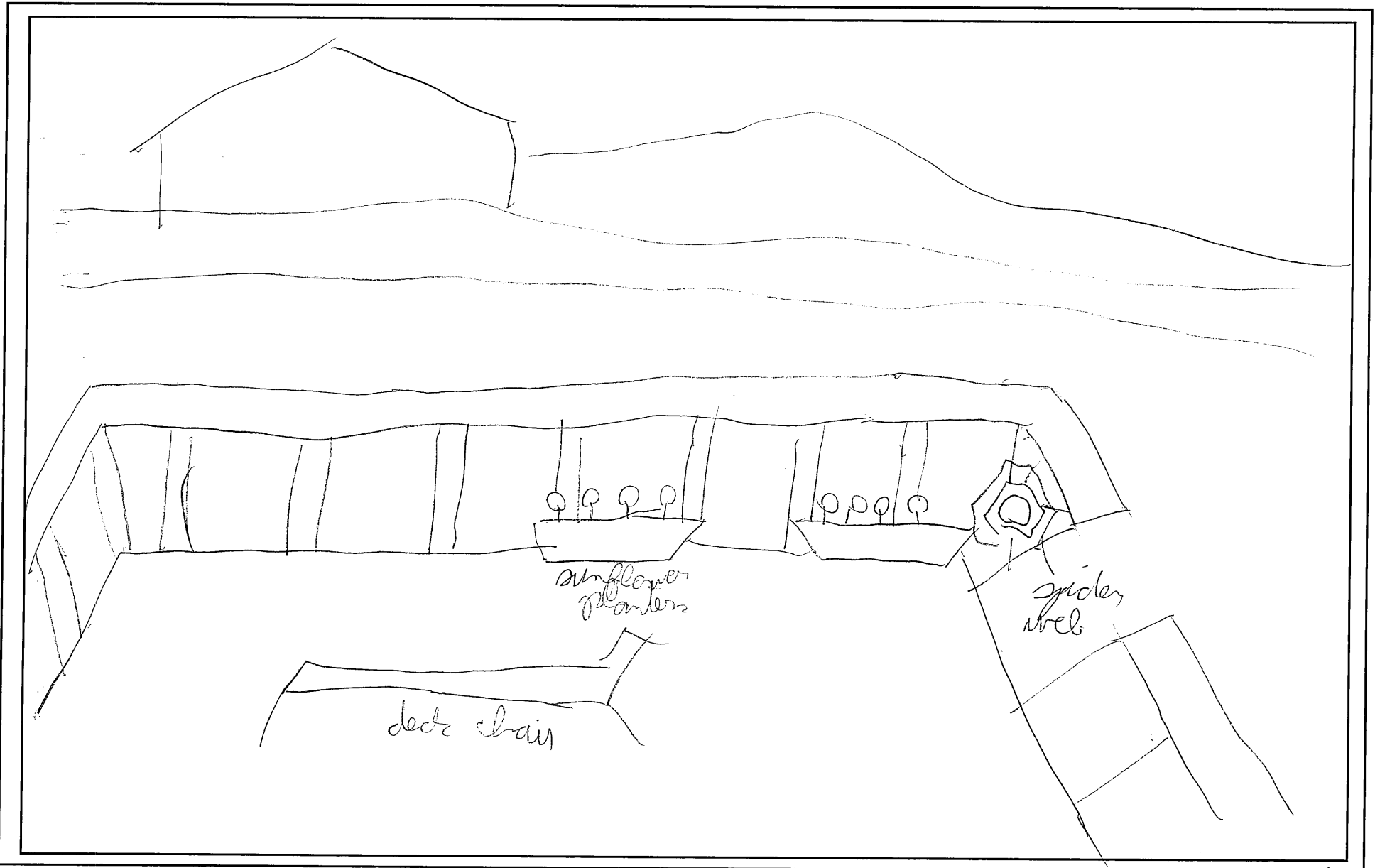
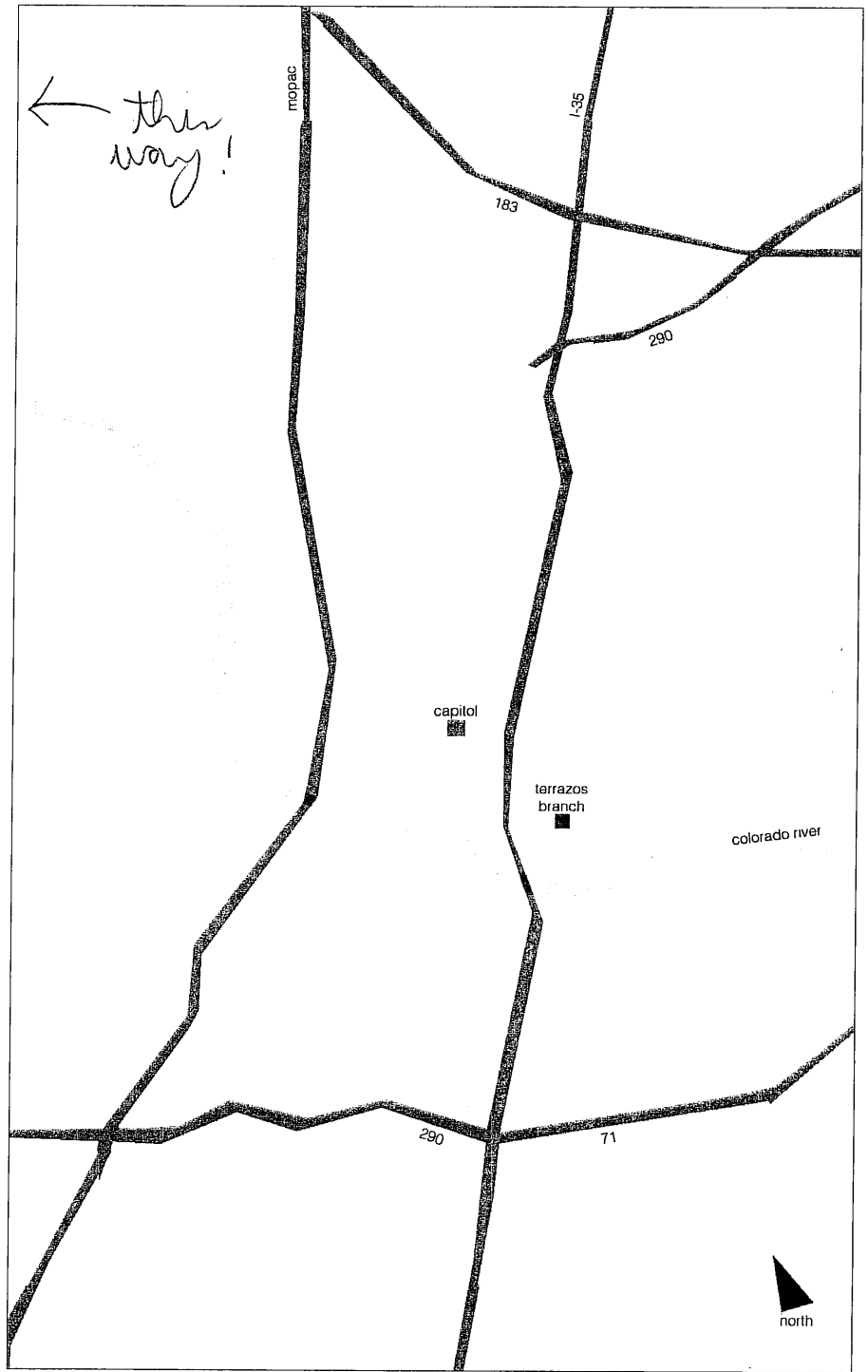

Written description/annotations of what you see out of your chosen window:

Window Frame

looking out at the back deck while I work



Name/Pen name (anonymity is fine too):

Amerity

Open Austin Talk / Austin's Atlas Survey Part 1

How long have you lived in Austin? Since 2001, minus grad school.

Do you rent or own? OWN.

Do you reside in a house, apartment, condo, mobile home, or HOUSE?

What floor do you live on? (or do you live on multiple floors)? First- only one floor.

What is your most common mode of transport? Bike.

What is that mode of transport most influenced by: convenience, philosophy, economic, traffic, other health.

How many miles do you travel to get to work/school (or where you go everyday)? less than 1 some days; 3+ others

How long does it take to travel that distance? less than 1: 7 minutes; 3+ depends

Do you enjoy your commute? Why or why not? Yes. I love not driving, decompressing in a buffer before/after work, & knowing nature + development

Open Austin Talk / Austin's Atlas Survey Part 2

A) Mark where you live on the adjacent map. You can be as vague (just use a dot) or as specific (include cross streets) as you like.

B) Visualize the window in your home that you look out the most--what do you see? Draw and describe with words in as much detail as possible below. Bring the view to life.

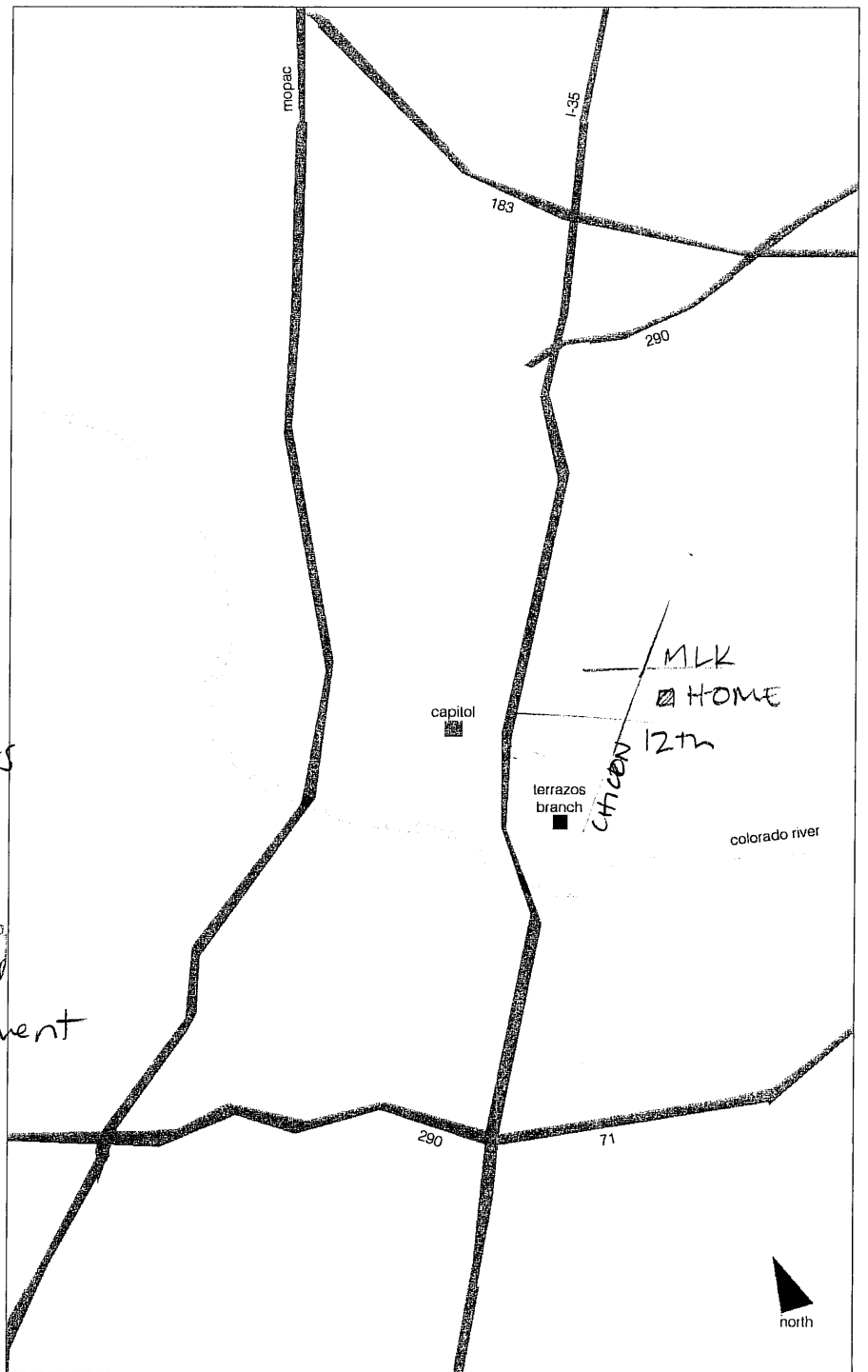

I've lived here six years. My husband has lived here 13 years.

**West-facing window:**  
 STANDING AT KITCHEN SINK  
 For six years, I've watched a girl become a teenager. I've seen her parents laugh + fight. I've seen tenants come and go from the other half of the duplex. There is a fence that does not provide much privacy since our house is higher off the ground. We had a friend weld a trellis. Now there are passionflower and sweet potato vines. Not total privacy, which is fine.

**North-facing window:**  
 THROUGH FRONT WINDOW  
 Right in front, there is a modest, historic house it has been there, with the same tenant, the entire time I've lived there. She was quiet and didn't like my husband's band practice. She sold off-market to a developer, and for the past few weeks I've seen a constant stream of real estate agents and prospective buyers come and go. I never knew her name, saw her face, or got to say goodbye.

Written description/annotations of what you see out of your chosen window:

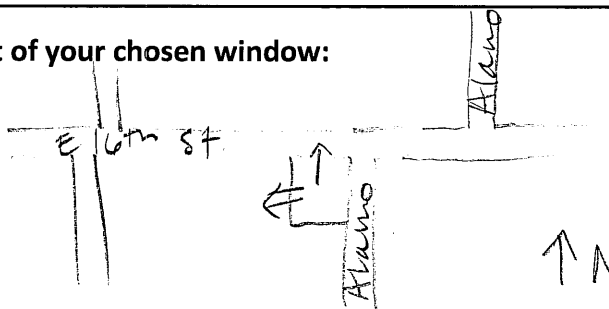

Window Frame

↑ North-facing viewpoint  
 ← West-facing viewpoint

Name/Pen name (anonymity is fine too):

Alex

Open Austin Talk / Austin's Atlas Survey Part 1

How long have you lived in Austin?

Full-time 4 years but I visit a lot (visited graduated UT 08 09 10)

Do you rent or own?

Rent

Do you reside in a house, apartment, condo, mobile home, or

Apt?

What floor do you live on? (or do you live on multiple floors)?

1st floor

What is your most common mode of transport?

Car

What is that mode of transport most influenced by:

convenience, philosophy, economic, traffic, other late night options.

How many miles do you travel to get to work/school (or where you go everyday)?

About 2.5 miles

How long does it take to travel that distance?

10-15 min

Do you enjoy your commute? Why or why not?

I like it since it's short and I like looking around Congress/familiar sights

Open Austin Talk / Austin's Atlas Survey Part 2

A) Mark where you live on the adjacent map. You can be as vague (just use a dot) or as specific (include cross streets) as you like.

B) Visualize the window in your home that you look out the most--what do you see? Draw and describe with words in as much detail as possible below. Bring the view to life.

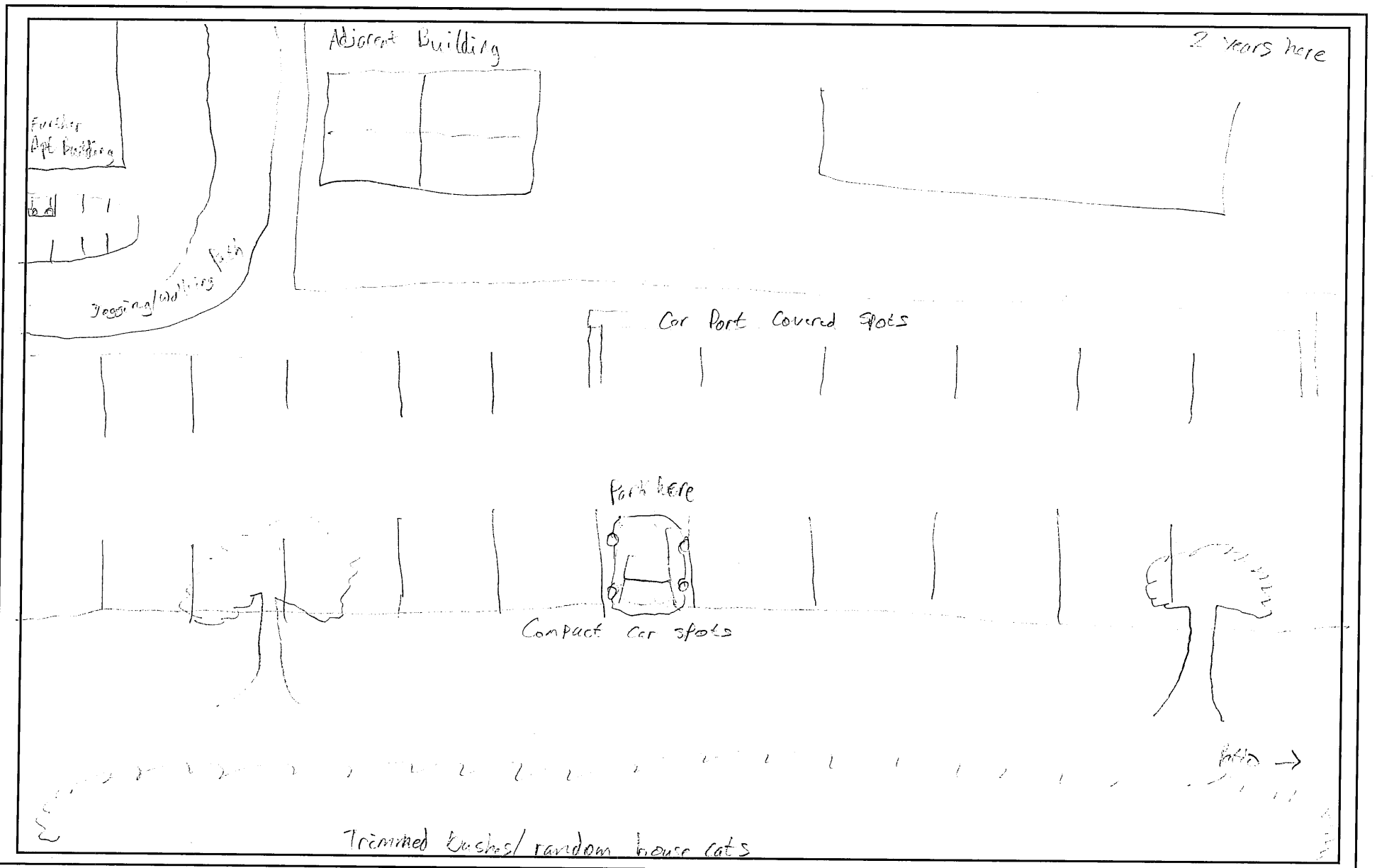
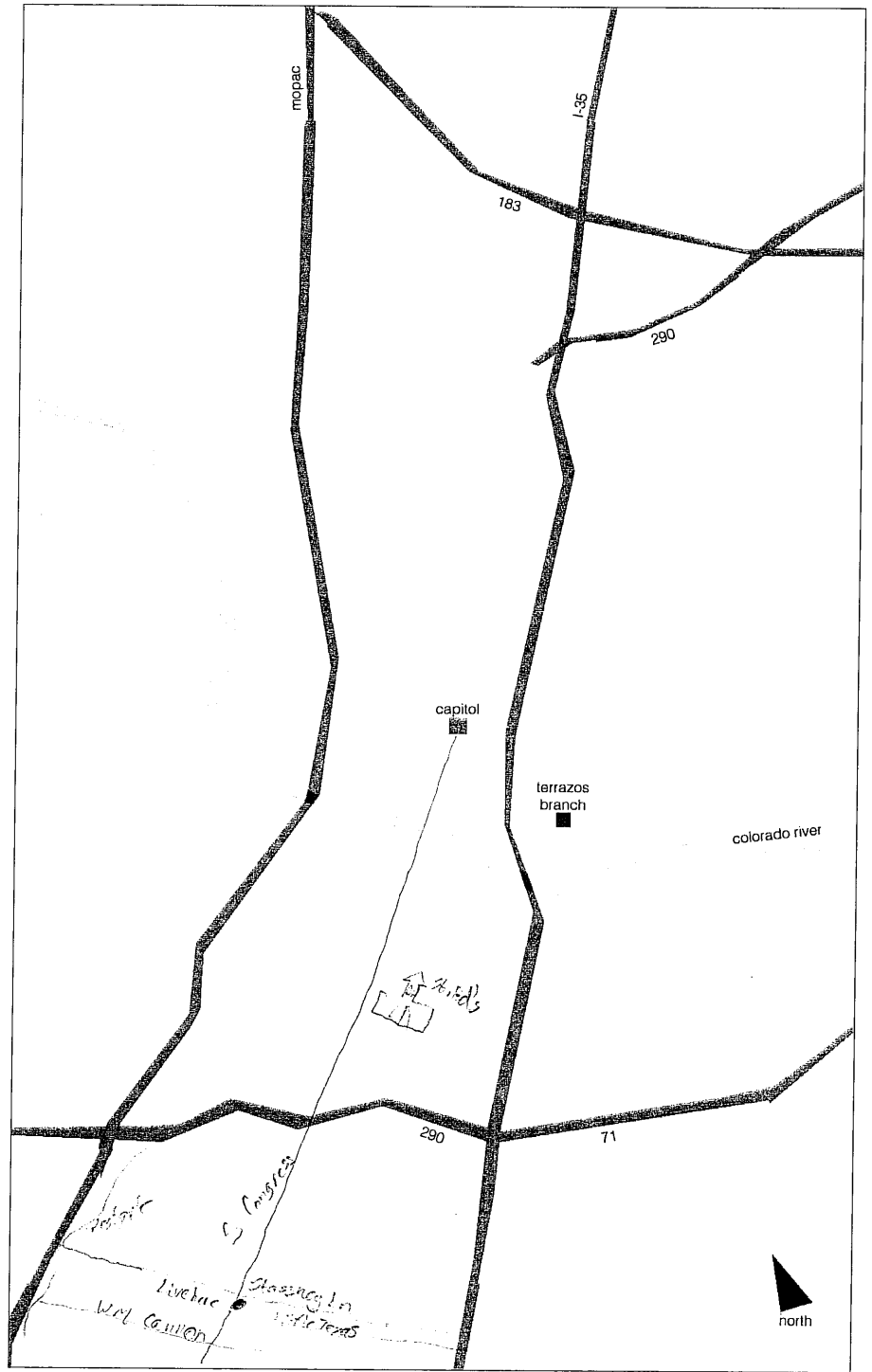

Written description/annotations of what you see out of your chosen window:

Window Frame

My bedroom window, away from desk. Not much of a view but I park here and think about papers

Name/Pen name (anonymity is fine too):

Open Austin Talk / Austin's Atlas Survey Part 1

How long have you lived in Austin? 3 years, lived here 6 months

Do you rent or own? Rent

Do you reside in a house, apartment, condo, mobile home, or \_\_\_\_\_? Apartment

What floor do you live on? (or do you live on multiple floors)? 2 (out of 4)

What is your most common mode of transport? Bus 70%  
Uber/Lyft + 15%  
walk 15%

What is that mode of transport most influenced by: convenience, philosophy economic, traffic, other \_\_\_\_\_.

How many miles do you travel to get to work/school (or where you go everyday)? 2 mi

How long does it take to travel that distance? 15 mins

Do you enjoy your commute? Why or why not? Yes, When I take the bus, I get to see the regular not rich tech people in Austin. walking, I get to see homeless.

Open Austin Talk / Austin's Atlas Survey Part 2

A) Mark where you live on the adjacent map. You can be as vague (just use a dot) or as specific (include cross streets) as you like.

B) Visualize the window in your home that you look out the most--what do you see? Draw and describe with words in as much detail as possible below. Bring the view to life.

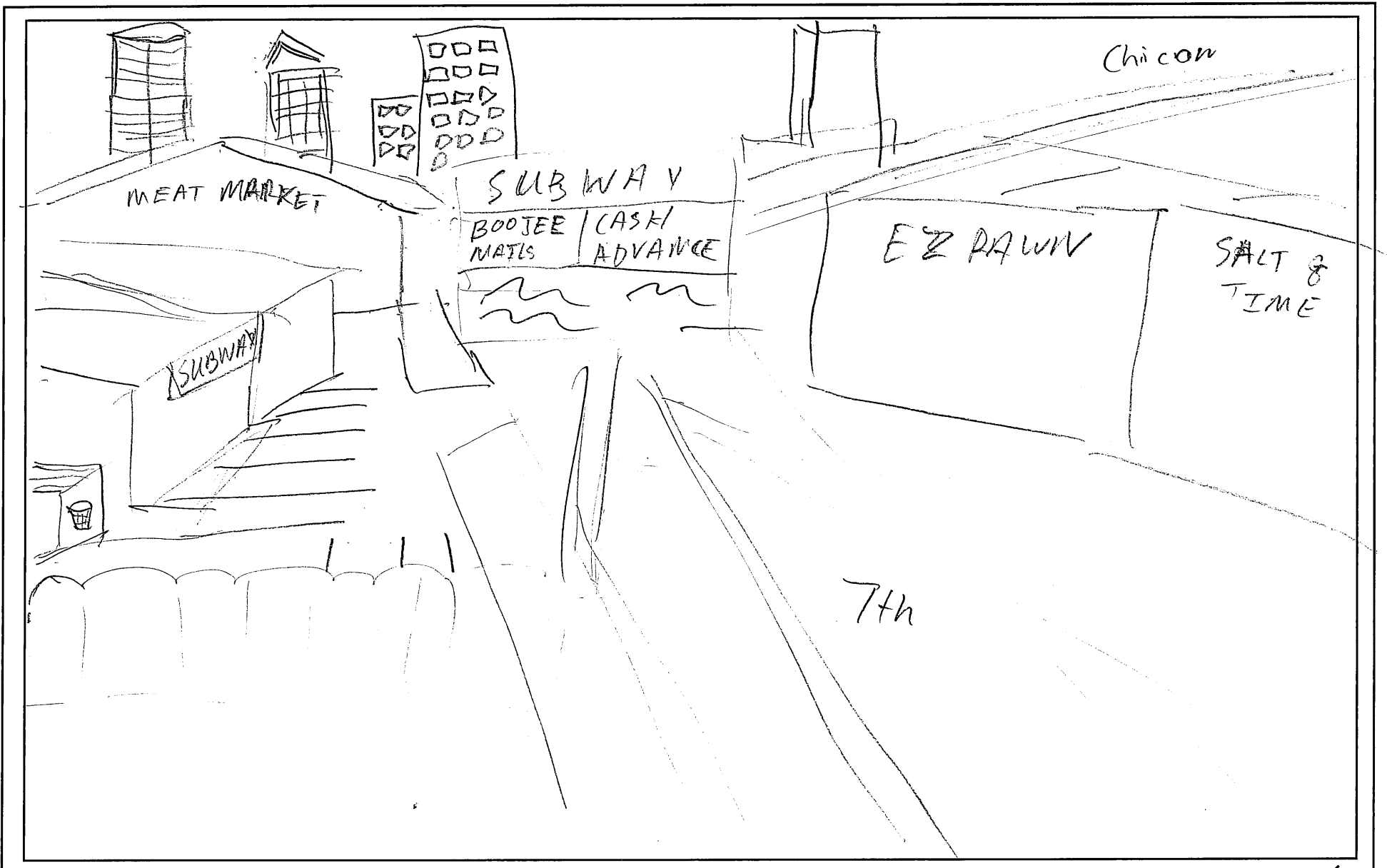
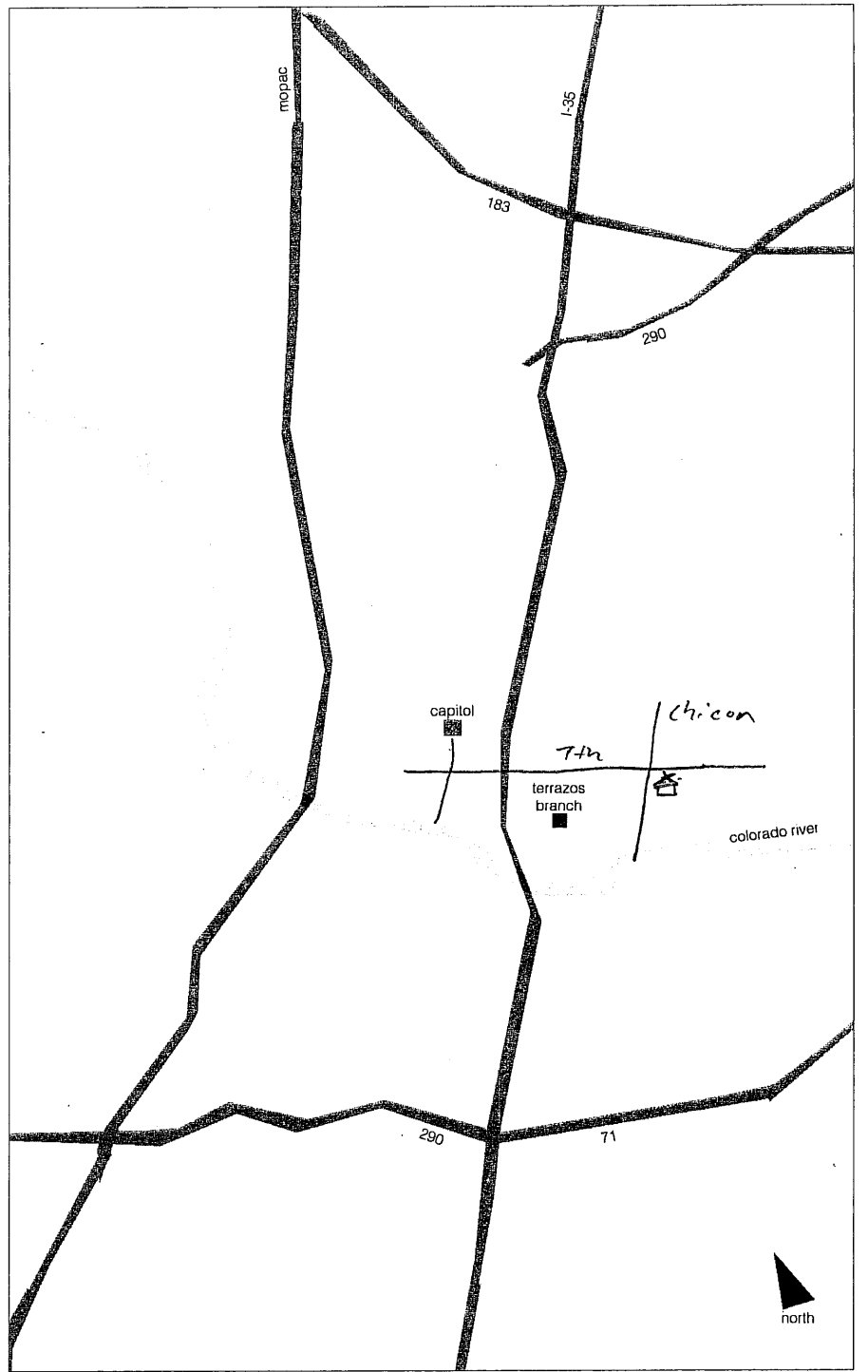

Written description/annotations of what you see out of your chosen window:

Subway, Cash Advance, Pawin Shop, Bojee Hair/ Nails, La Michocena, Huston Tilitso  
Dog park, People walking their dogs, Cellphone Tower,  
Downtown (BoA bldg, WeWork Bldg, SW Marriott, Austonian).  
Welding shop, Sidewalk, Bus 4, Cars. Loud, drunk white people.  
Poor people. Trees. Parking lot. Garbage dumpster.

Name/Pen name (anonymity is fine too):

Kelvin

**Open Austin Talk / Austin's Atlas Survey Part 1**

How long have you lived in Austin? *55 1/2 years - my whole life*

Do you rent or own? *Lived here 8 years*

Do you reside in a house, apartment, condo, mobile home, or house?

What floor do you live on? (or do you live on multiple floors)? *ground floor*

What is your most common mode of transport? *car*

What is that mode of transport most influenced by: convenience, philosophy, economic, traffic, other \_\_\_\_\_.

How many miles do you travel to get to work/school (or where you go everyday)? *Drive my daughter to high school*

How long does it take to travel that distance? *2 mi round trip*

Do you enjoy your commute? Why or why not?  
*It's a boring trip + she should really be riding a bike*

**Open Austin Talk / Austin's Atlas Survey Part 2**

A) Mark where you live on the adjacent map. You can be as vague (just use a dot) or as specific (include cross streets) as you like.

B) Visualize the window in your home that you look out the most--what do you see? Draw and describe with words in as much detail as possible below. Bring the view to life.

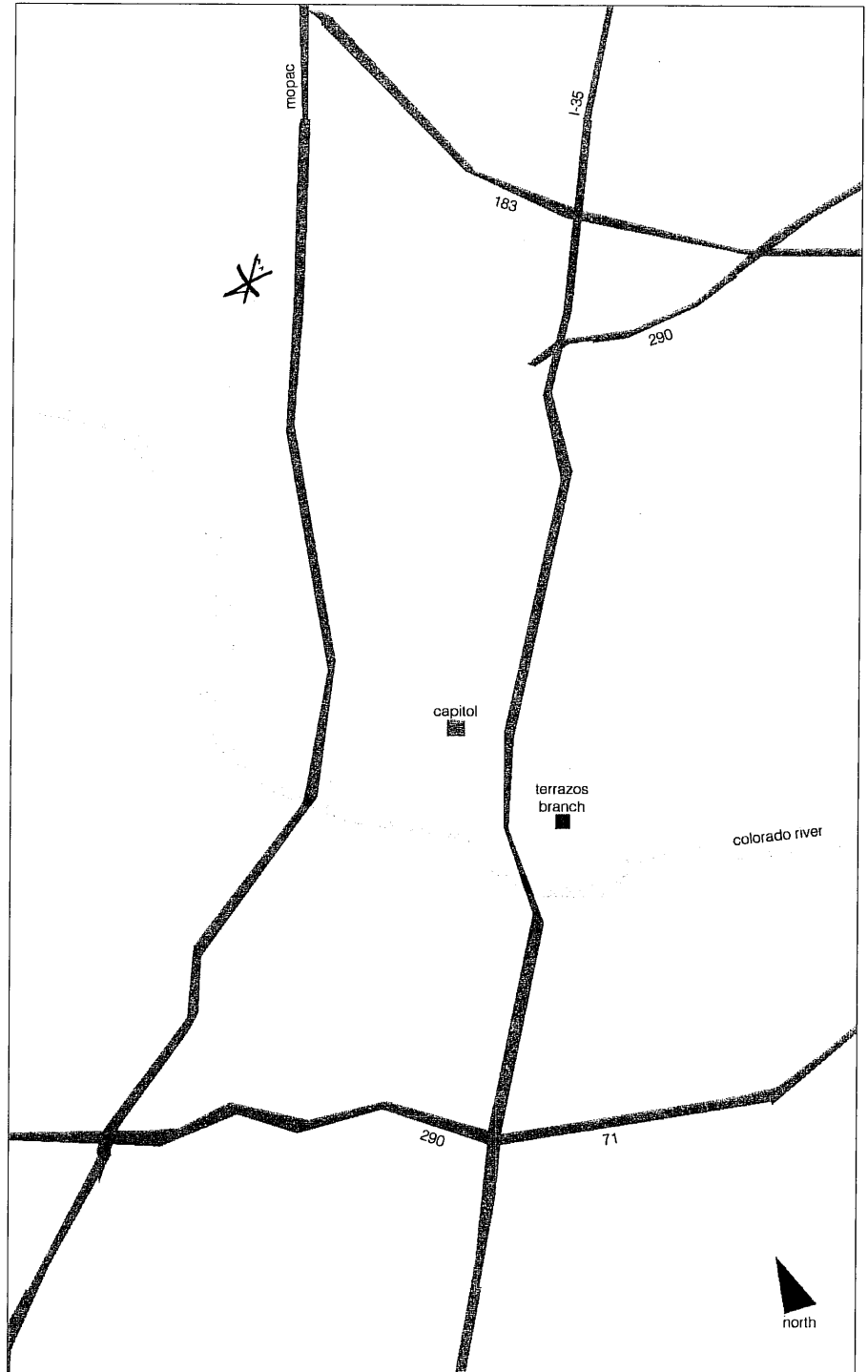

*Double glass door on my study  
→ so the "frame" is tall/narrow. → but I'll ignore the framing & draw the view*

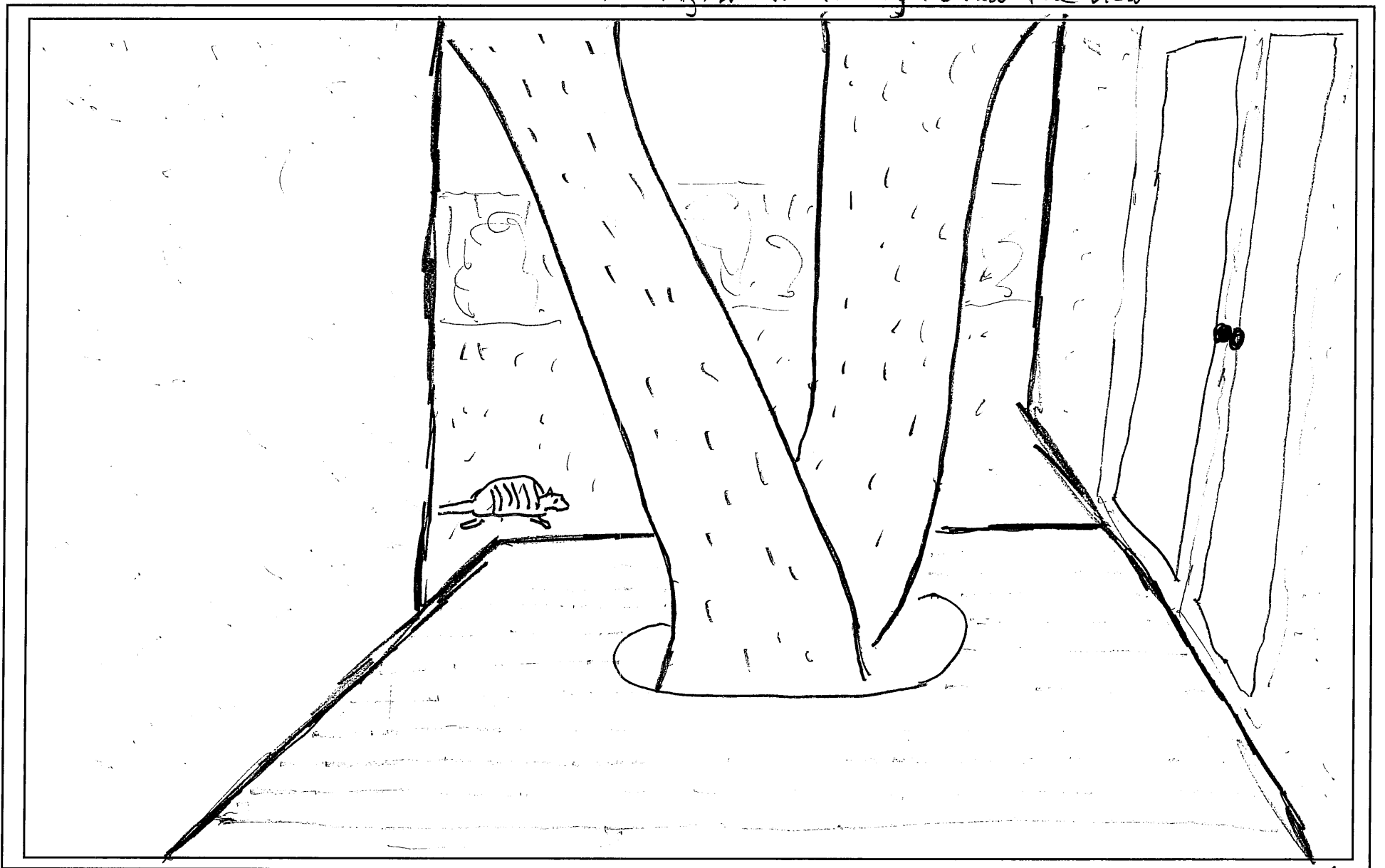

Written description/annotations of what you see out of your chosen window:

Window Frame

*The view out the study: A small deck made of cedar slats. A large double-trunk oak growing out of a hole in the deck. This side of the house was built around the tree - so the deck is surrounded by three exterior walls of the house. The tree mostly blocks my view of anything else. Sometimes an armadillo sneaks into the back yard and noses around the deck and provides a few minutes of entertainment.*

Name/Pen name (anonymity is fine too):

Open Austin Talk / Austin's Atlas Survey Part 1

How long have you lived in Austin? 13 YEARS

Do you rent or own? OWN

Do you reside in a house, apartment, condo, mobile home, or HOUSE?

What floor do you live on? (or do you live on multiple floors)? 1

What is your most common mode of transport? BICYCLE

What is that mode of transport most influenced by: convenience, philosophy, economic, traffic, other \_\_\_\_\_.

How many miles do you travel to get to work/school (or where you go everyday)? 6 ish

How long does it take to travel that distance? 20-35 MINUTES  
Depending on MOOD

Do you enjoy your commute? Why or why not?  
YES, USUALLY

Open Austin Talk / Austin's Atlas Survey Part 2

A) Mark where you live on the adjacent map. You can be as vague (just use a dot) or as specific (include cross streets) as you like.

B) Visualize the window in your home that you look out the most--what do you see? Draw and describe with words in as much detail as possible below. Bring the view to life.

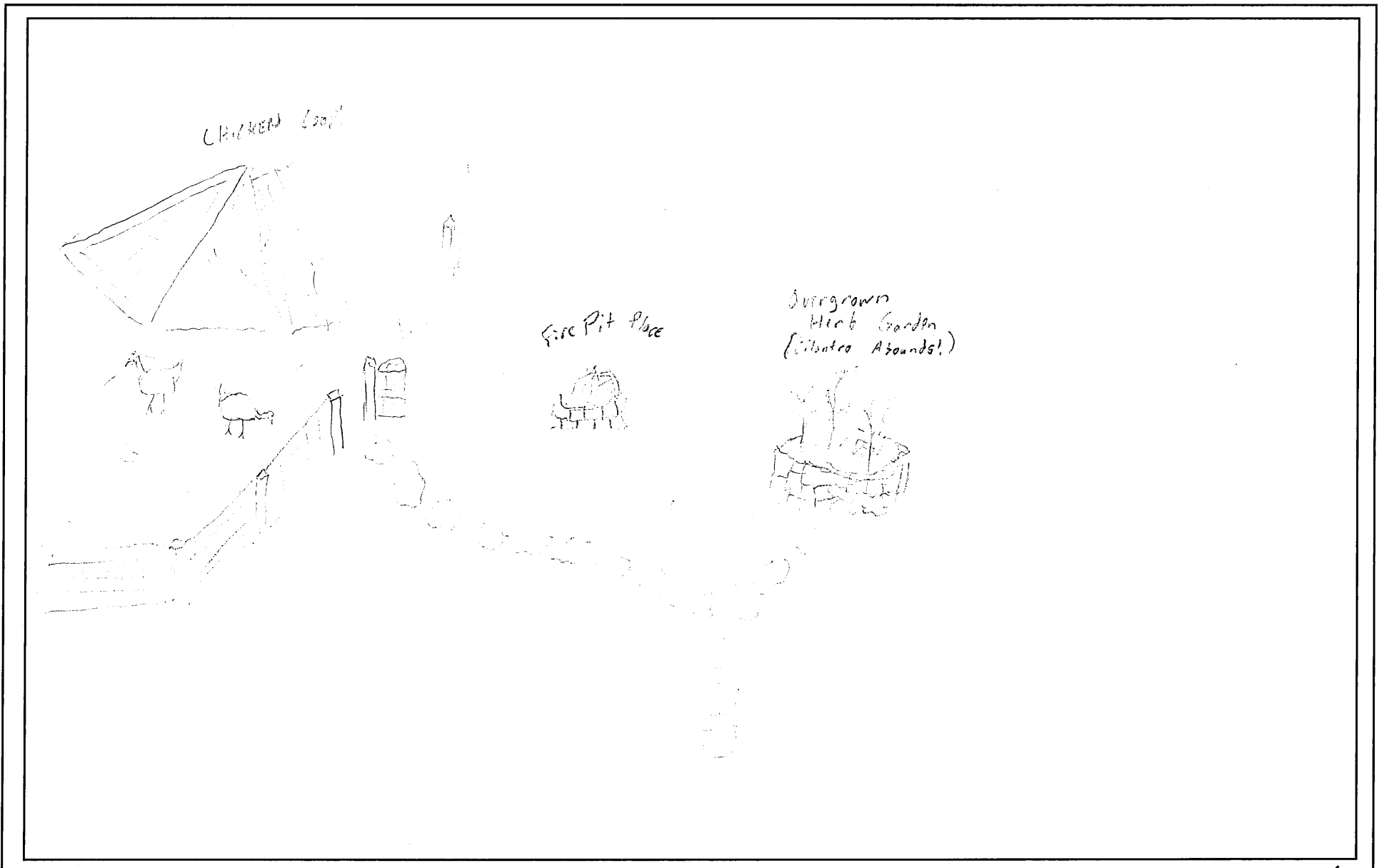
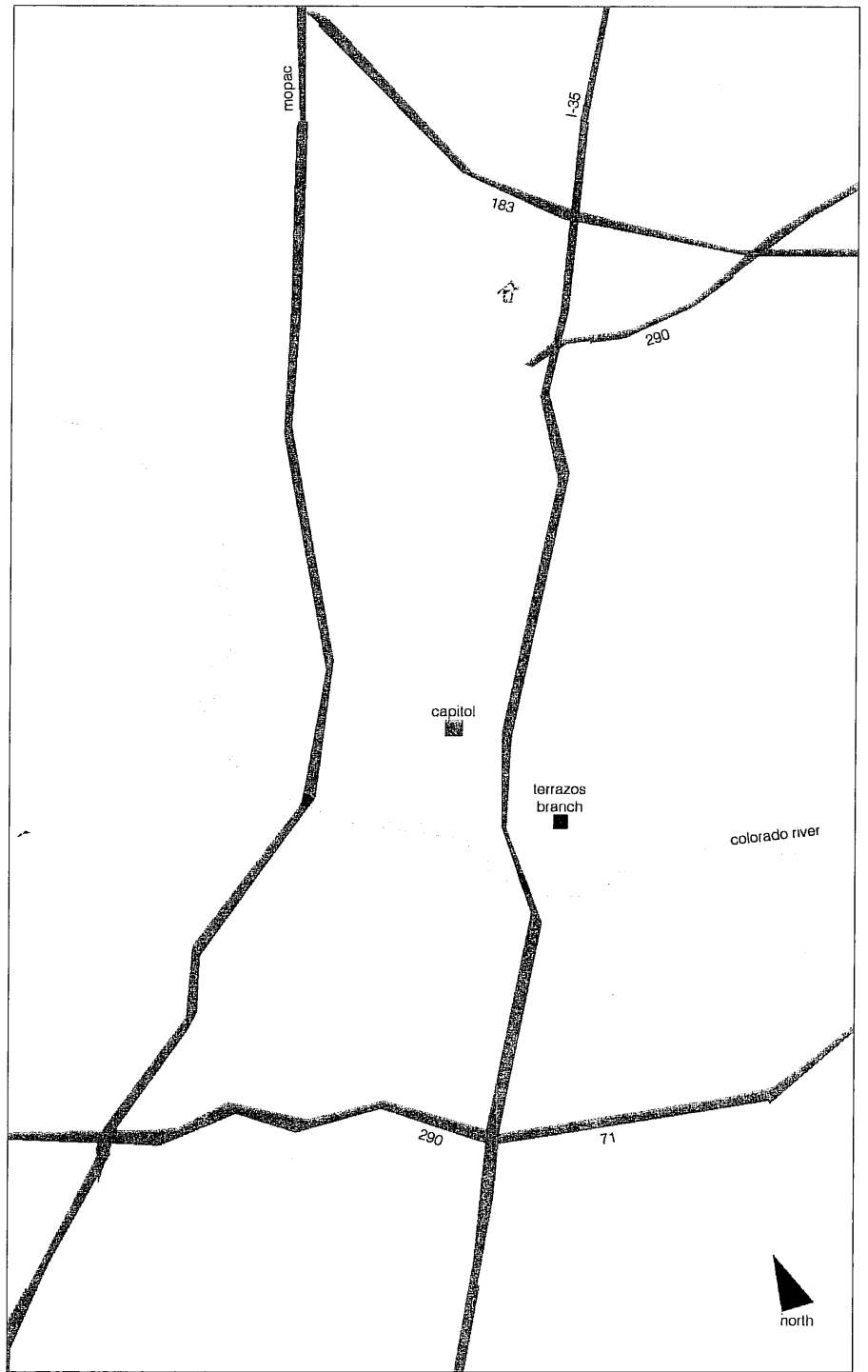

Written description/annotations of what you see out of your chosen window:

Window Frame

Name/Pen name (anonymity is fine too):

Victoria O'Dell

Open Austin Talk / Austin's Atlas Survey Part 1

How long have you lived in Austin? 10 months

Do you rent or own? Rent

Do you reside in a house, apartment, condo, mobile home, or Duplex/Apt?

What floor do you live on? (or do you live on multiple floors)?

1st Floor

What is your most common mode of transport?

bus/carpooling

What is that mode of transport most influenced by:

convenience, philosophy, economic, traffic, other

All the Above

How many miles do you travel to get to work/school (or where you go everyday)?

~ 3.5 miles to work

How long does it take to travel that distance?

~ 20 minutes

Do you enjoy your commute? Why or why not?

yes, when im on the bus, I get time to read.

Open Austin Talk / Austin's Atlas Survey Part 2

A) Mark where you live on the adjacent map. You can be as vague (just use a dot) or as specific (include cross streets) as you like.

B) Visualize the window in your home that you look out the most--what do you see? Draw and describe with words in as much detail as possible below. Bring the view to life.

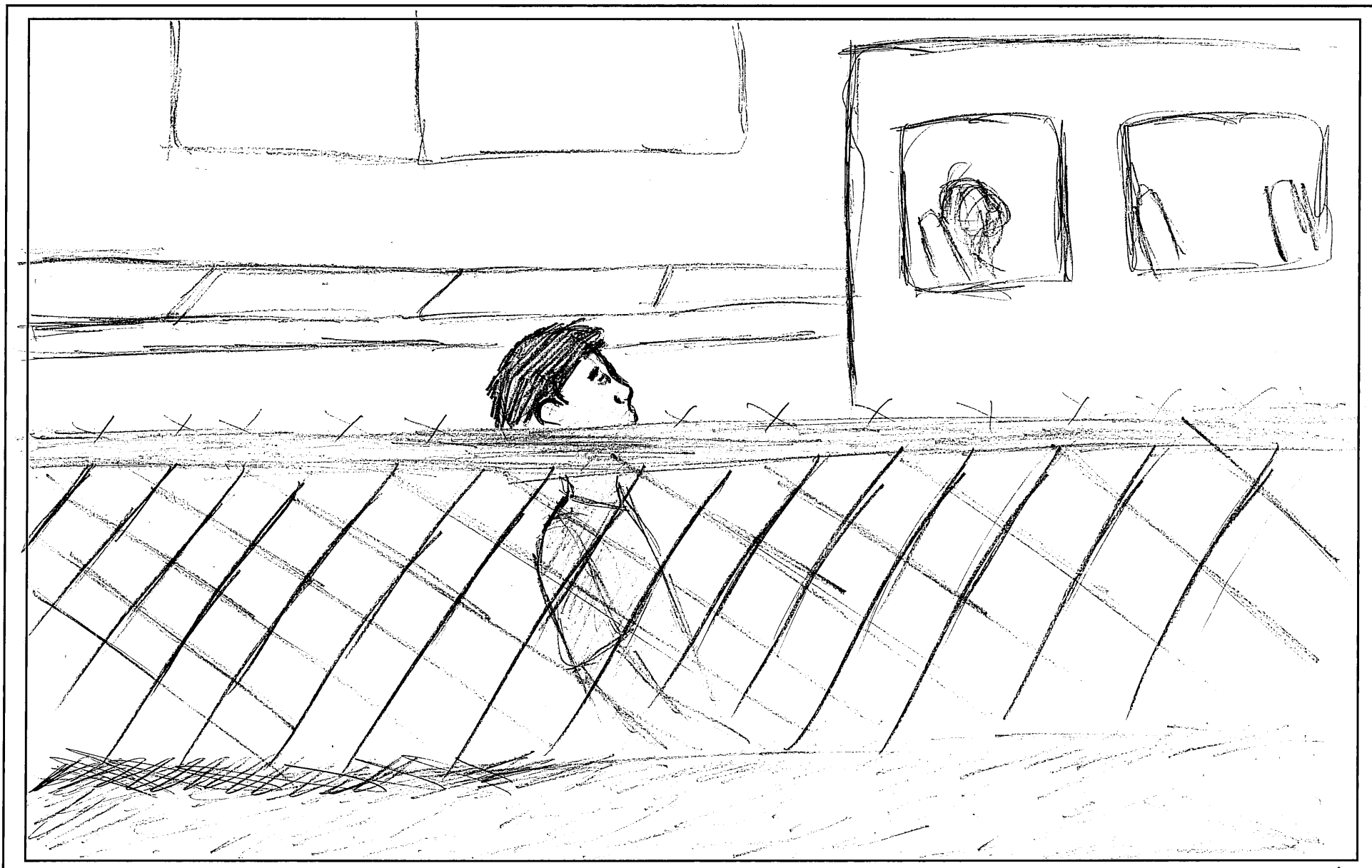
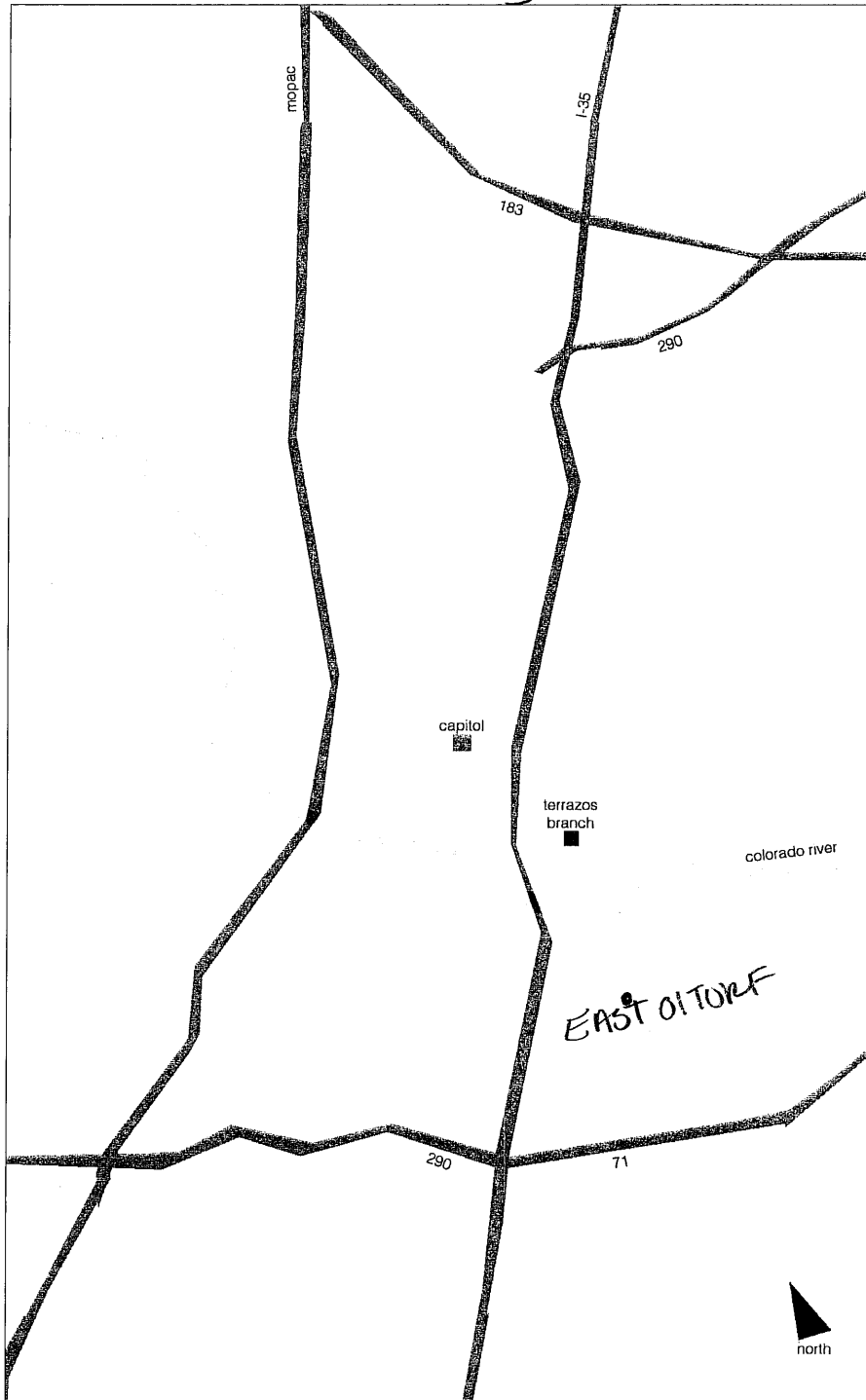

Written description/annotations of what you see out of your chosen window:

Window Frame

The back of the complex I live in  
 There is a fence where people often pass by  
 Since there is a bus stop + concierge stone dist a couple  
 steps down. I'm on an incline so I only see the top half of people

Name/Pen name (anonymity is fine too):

Open Austin Talk / Austin's Atlas Survey Part 1

How long have you lived in Austin?

4 months

Do you rent or own?

rent

Do you reside in a house, apartment, condo, mobile home, or

upward tent?

What floor do you live on? (or do you live on multiple floors)? 2<sup>nd</sup>

What is your most common mode of transport? car

What is that mode of transport most influenced by: convenience philosophy, economic, traffic, other distance.

How many miles do you travel to get to work/school (or where you go everyday)? 20, near airport

How long does it take to travel that distance? 19 min

Do you enjoy your commute? Why or why not? No, its boring clean landscape. I enjoy my breakfast during that commute

Open Austin Talk / Austin's Atlas Survey Part 2

A) Mark where you live on the adjacent map. You can be as vague (just use a dot) or as specific (include cross streets) as you like.

B) Visualize the window in your home that you look out the most--what do you see? Draw and describe with words in as much detail as possible below. Bring the view to life.

Apartment and circle in the center, sometimes kind use they run on steel surface and they make noise Buda, Tx

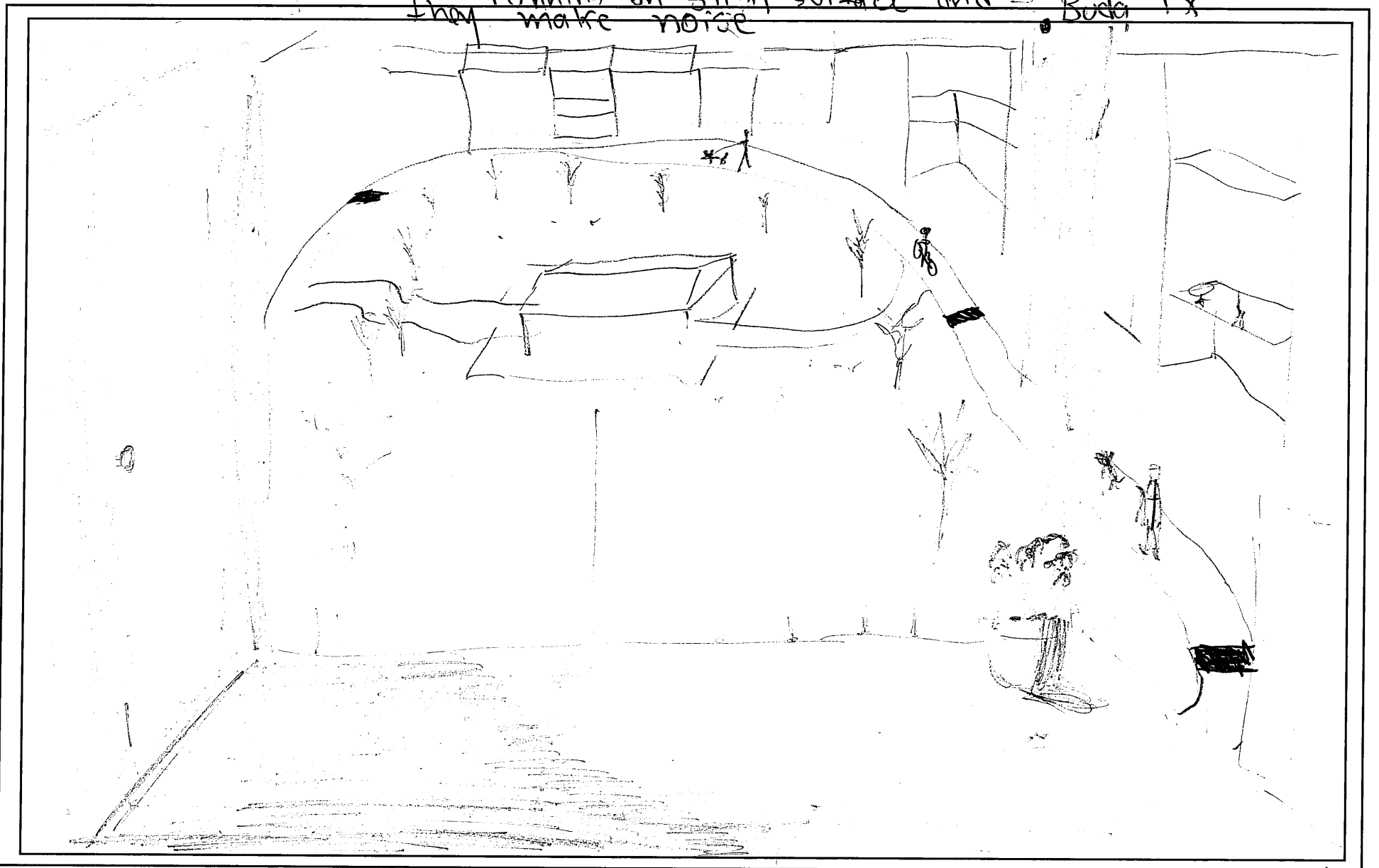
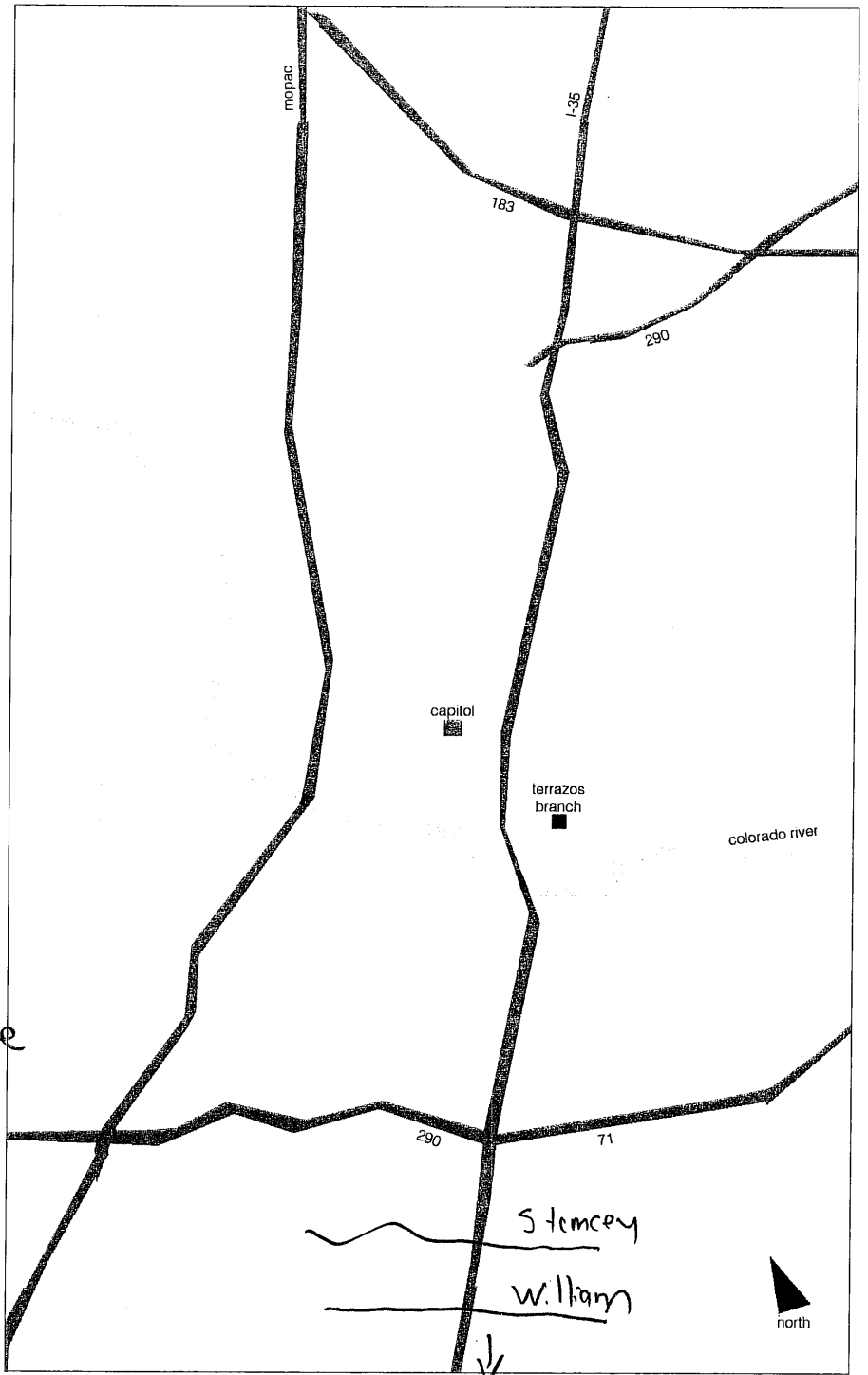

Written description/annotations of what you see out of your chosen window:

Window Frame



Name/Pen name (anonymity is fine too):

Open Austin Talk / Austin's Atlas Survey Part 1

How long have you lived in Austin?

Grew up here, but just moved back after 6 years away

Do you rent or own?

Do you reside in a house, apartment, condo, mobile home, or Apartment?

What floor do you live on? (or do you live on multiple floors)? 2nd

What is your most common mode of transport?

Bus or car

What is that mode of transport most influenced by: convenience, philosophy, economic, traffic, other weather.

How many miles do you travel to get to work/school (or where you go everyday)? 2 mi

How long does it take to travel that distance?

10-20 minutes

Do you enjoy your commute? Why or why not?

Yes, I look forward to my quiet time on the bus reading or listening to music

Open Austin Talk / Austin's Atlas Survey Part 2

A) Mark where you live on the adjacent map. You can be as vague (just use a dot) or as specific (include cross streets) as you like.

B) Visualize the window in your home that you look out the most--what do you see? Draw and describe with words in as much detail as possible below. Bring the view to life.

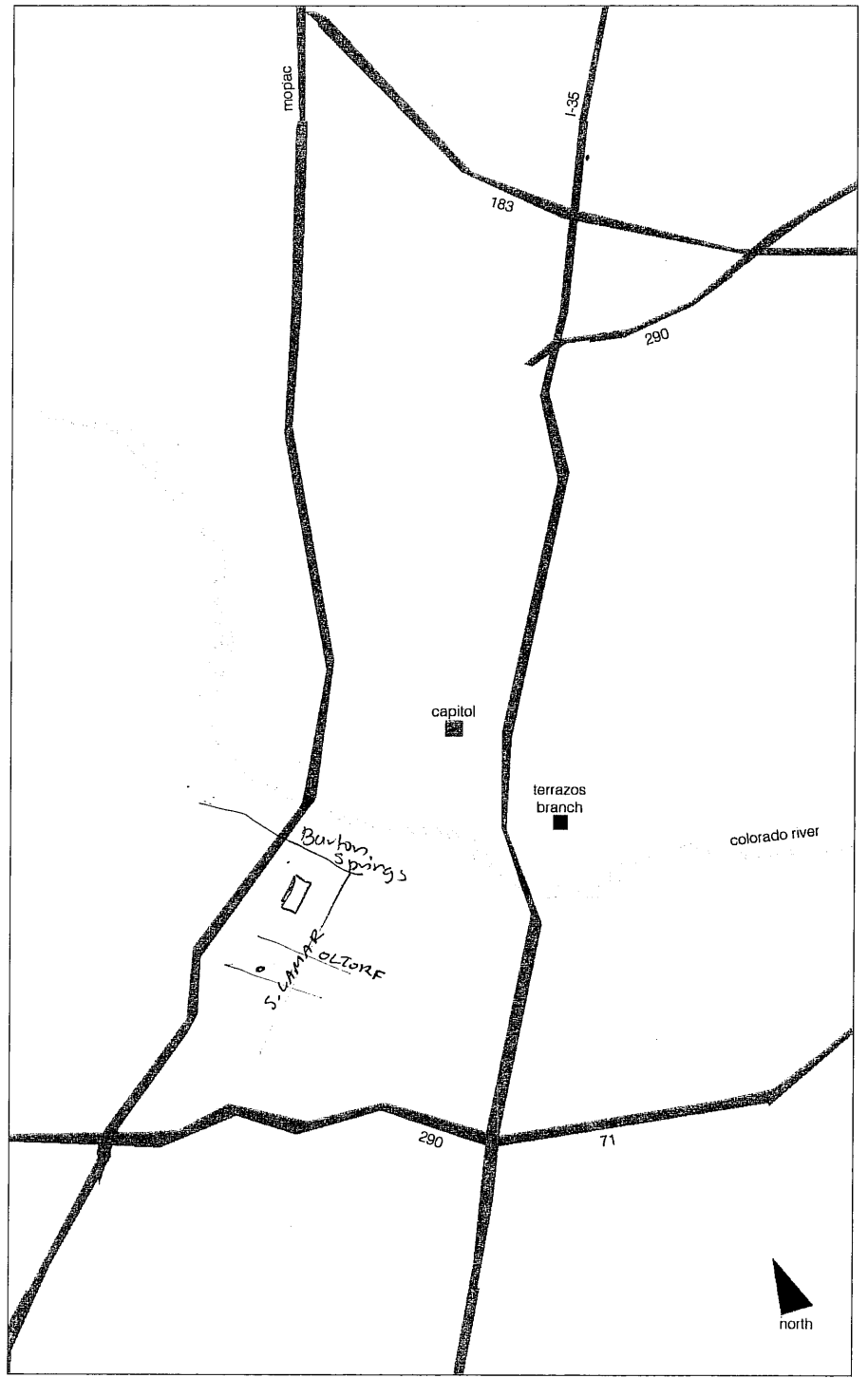

My apartment's window is right above a big TV. My boyfriend likes the TV, but I think it competes with the window.

I like to watch the sky change colors as I sit on the couch. We look out onto a big shed with a green metal roof. It makes rain sound so dramatic.

rain guitar - it just snorts out water from the 2nd story

beautiful clouds (Music from) Zillax

SOPHIE

I always hear my neighbor Jack calling for his stray cat

Someone macrame-ed the blind cords so now it looks like a little man dangling & chilling out.

I've lived here on and off for 2-3 years.

This is the view from sitting on my couch.

metal roof

my string of pearl plant

An amazing orchid from my BF for my Bday. All the flowers fell off, but I let it to bloom again

These plants don't get enough light

hispotnos keeps growing big leaves, but won't grow bigger

Record player

Written description/annotations of what you see out of your chosen window:

Window Frame